

Datasheet of 25KATS10RVX Quick coupling with hose barb in panel mount

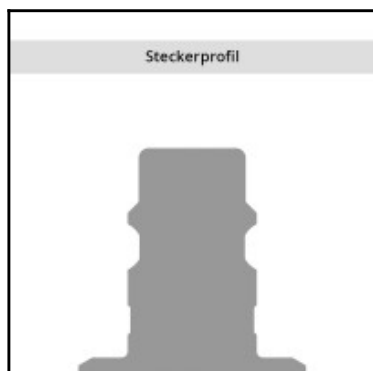
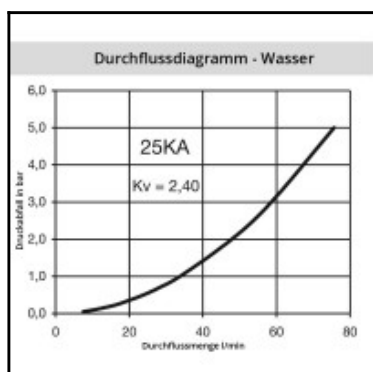
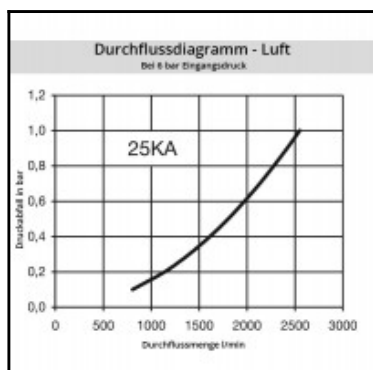
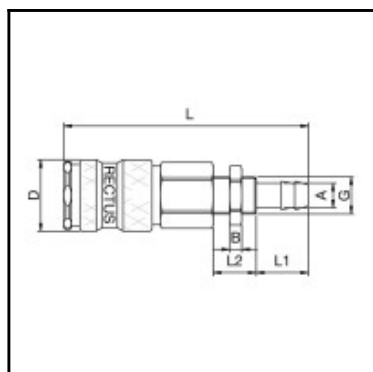

Description

Quick coupling single shut-off, panel mount with hose barb 10mm, nominal diameter 7,8, <35 bar, stainless steel AISI 303, seal FKM

Universal industrial coupling with standard European profile for use with gaseous, liquid and aggressive media. Coupling system with single-hand operation. UltraFlo valve for optimum flow and low pressure drop. The series stands out for its robust design and long service life even with the harshest use. The collar design minimises damage to the valve body.

Details

| | |
|---|--|
| Series: | 25 |
| Series long: | 25KA |
| Bore in mm: | 7,8 |
| Bore area in mm²: | 48 |
| Advantages: | One-hand operation. Robust structure. UltraFlo valve. |
| Compatibility: | RECTUS 26 European standard profiles |
| Working pressure: | 35 bar maximum static working pressure with safety factor 4 to 1. |
| Working temperature: | -20°C up to +100°C (NBR) -40°C up to +120/150°C (EPDM) -15°C up to +200°C (FKM) depending on the medium. |
| Shut-Off: | Quick coupling Single Shut-Off |
| Connection: | Hose barb in Panel mount 10mm |
| Connection description: | Hose barb in Panel mount 10mm |
| Connection type: | Hose barb |
| Material: | stainless steel AISI 303 |
| Material description: | stainless steel AISI 303 |
| Seal description: | Fluororubber |
| Surface: | blank finish |
| Material connection: | stainless steel AISI 303 |
| Material valve body: | stainless steel AISI 303 |
| Material sleeve: | stainless steel AISI 303 |
| Material valve: | stainless steel AISI 303 |
| Material spring snap ring: | stainless steel AISI 301 |
| Material balls/pins: | Stainless steel AISI 316 |
| Material seal: | Viton® |
| Weight in kg: | 0,11 |
| Self-venting coupling: | No |
| Safety locking system: | No |
| Single-hand operation: | Yes |
| Two-hand operation: | No |
| Ball locking: | Yes |
| Pin lock: | No |
| Ultra-FLO-valve: | No |
| Vacuum suitable: | No |
| Water-resistant: | No |
| Flat-sealing: | No |
| Suitable breath / respiratory protection: | No |
| Pressure eliminator: | No |
| Hydraulics: | No |
| Pneumatics: | Yes |
| Standard product: | No |
| Mould coupling: | No |

Dimensions

| | |
|---------------|----------|
| Connection A: | 10 mm |
| B mm: | 4 |
| D mm: | 23 |
| G mm: | M 14 x 1 |
| L mm: | 79,5 |
| L1 mm: | 25 |
| L2 mm: | 14 |
| SW mm: | 19 |
| SW1 mm: | 19 |