

## Datasheet of 25KAKO12RVX Quick coupling with male thread

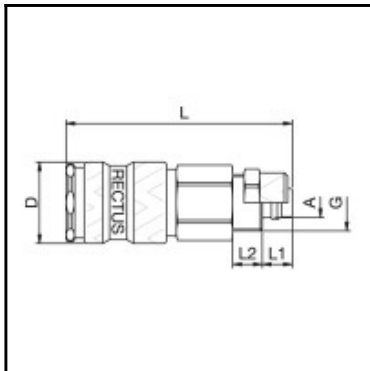

### Description

Quick coupling single shut-off, with hose nut 9 x 12 mm, nominal diameter 7,8, <35 bar, stainless steel AISI 303, seal FKM

Universal industrial coupling with standard European profile for use with gaseous, liquid and aggressive media. Coupling system with single-hand operation. UltraFlo valve for optimum flow and low pressure drop. The series stands out for its robust design and long service life even with the harshest use. The collar design minimises damage to the valve body.

### Details

Series:	25
Series long:	25KA
Bore in mm:	7,8
Bore area in mm²:	48
Advantages:	One-hand operation. Robust structure. UltraFlo valve.
Compatibility:	RECTUS 26 European standard profiles
Working pressure:	35 bar maximum static working pressure with safety factor 4 to 1.
Working temperature:	-20°C up to +100°C (NBR) -40°C up to +120/150°C (EPDM) -15°C up to +200°C (FKM) depending on the medium.
Shut-Off:	Quick coupling Single Shut-Off
Connection:	with tube nut 9 x 12 mm
Connection description:	with tube nut 9 x 12 mm
Connection type:	Connection nut
Material:	stainless steel AISI 303
Material description:	stainless steel AISI 303
Seal description:	Fluororubber
Surface:	blank finish
Material connection:	stainless steel AISI 303
Material valve body:	stainless steel AISI 303
Material sleeve:	stainless steel AISI 303
Material valve:	stainless steel AISI 303
Material spring snap ring:	stainless steel AISI 301
Material balls/pins:	Stainless steel AISI 316
Material seal:	Viton®
Weight in kg:	0,1059
Self-venting coupling:	No
Safety locking system:	No
Single-hand operation:	Yes
Two-hand operation:	No
Ball locking:	Yes
Pin lock:	No
Ultra-FLO-valve:	No
Vacuum suitable:	No
Water-resistant:	No
Flat-sealing:	No
Suitable breath / respiratory protection:	No
Pressure eliminator:	No
Hydraulics:	No
Pneumatics:	Yes
Standard product:	No
Mould coupling:	No

### Dimensions

Connection A:	9 x 12 mm
D mm:	23
G mm:	M 16 x 1
L mm:	64,5
L1 mm:	9
L2 mm:	8
SW mm:	19