

## Datasheet of 3816 62 00 Straight bulkhead connector

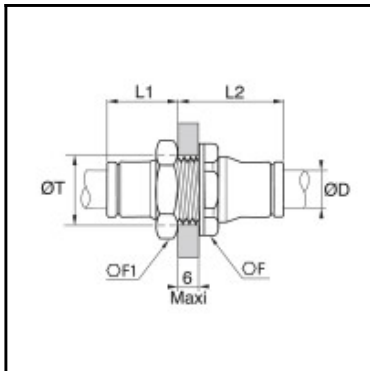

### Description

LF 3800 / LF 3900 - Stainless steel, straight bulkhead connector, Stainless steel 316I, 1/2 - 1/2

Connects 2 tubes through a panel.

- materials: Stainless steel, sealings: FKM.
- stainless steel components and FKM seals for use in aggressive environments
- strong construction and compact
- hygienic design aimed at reducing retention zones for safe and easy cleaning ( $R_a < 0,8$  surface)
- permitting permanent contact with foodstuffs
- individual unit quality control and dating in order to guarantee quality and traceability
- materials conforming to FDA and 1934/2004 CE standards

### Details

ØD:	1/2"
F:	27
F1:	27
L1:	20
L2:	28,956
T:	20,066
Maximum working pressure in bar:	30
Material seal ring:	Stainless steel 316I
Material seal:	FKM
Material body:	Stainless steel 316I
Material release button:	Stainless steel 303
Material union nut:	Stainless steel 316I
min. temperature in °C:	-20
max. temperature in °C:	120
RoHS compliant:	Yes
Weight in kg:	0,076

### Dimensions

ØD:	1/2"
F:	27
F1:	27
L1:	20
L2:	28,956
T:	20,066