

## Datasheet of 3808 08 17 T-stud coupling

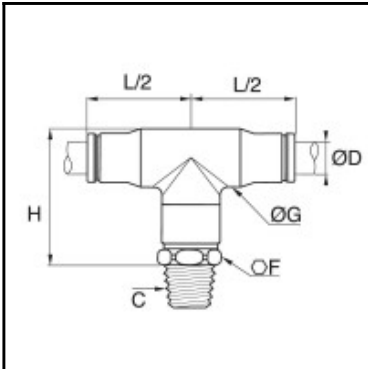

### Description

LF 3800 / LF 3900 - Stainless steel, T-stud coupling, Stainless steel 316l, 2 x 8 mm - R3/8

Connection of 2 tubes at a 90° angle to a threaded port

- materials: Stainless steel, sealings: FKM
- stainless steel components and FKM seals for use in aggressive environments
- strong construction and compact
- hygienic design aimed at reducing retention zones for safe and easy cleaning ( $R_a < 0,8$  surface)
- permitting permanent contact with foodstuffs
- individual unit quality control and dating in order to guarantee quality and traceability
- materials conforming to FDA and 1934/2004 CE standards

### Details

ØD:	8 mm
C:	R3/8"
F:	19
G:	15
H:	33
Maximum working pressure in bar:	30
Material seal ring:	Stainless steel 316l
Material seal:	FKM
Material body:	Stainless steel 316l
Material threaded fitting:	Stainless steel 316l
Material release button:	Stainless steel 303
min. temperature in °C:	-20
max. temperature in °C:	120
RoHS compliant:	Yes
Weight in kg:	0,068

### Dimensions

ØD:	8 mm
C:	R3/8"
F:	19
G:	15
H:	33