

Datasheet of 3808 06 14 T-stud coupling

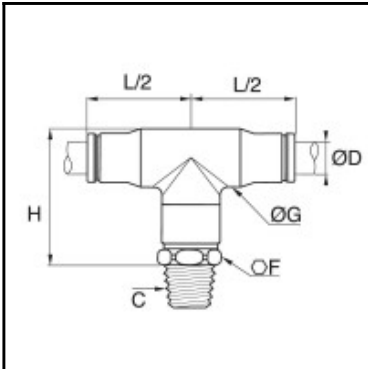

Description

LF 3800 / LF 3900 - Stainless steel, T-stud coupling, Stainless steel 316L, 2 x 6 mm - NPT1/4

Connection of 2 tubes at a 90° angle to a threaded port
materials: Stainless steel, sealings: FKM,
stainless steel components and FKM seals for use in aggressive environments,
strong construction and compact,
hygienic design aimed at reducing retention zones for safe and easy cleaning ($R_a < 0,8$ surface),
permitting permanent contact with foodstuffs,
individual unit quality control and dating in order to guarantee quality and traceability,
materials conforming to FDA and 1934/2004 CE standards.

Details

ØD:	6 mm
C:	NPT1/4"
F:	14
G:	12,5
H:	30
Maximum working pressure in bar:	30
Material seal ring:	Stainless steel 316l
Material seal:	FKM
Material body:	Stainless steel 316l
Material threaded fitting:	Stainless steel 316l
Material release button:	Stainless steel 303
min. temperature in °C:	-20
max. temperature in °C:	120
RoHS compliant:	Yes
Weight in kg:	0,044

Dimensions

ØD:	6 mm
C:	NPT1/4"
F:	14
G:	12,5
H:	30