

Datasheet of 3204 03 00 Equal and unequal tee

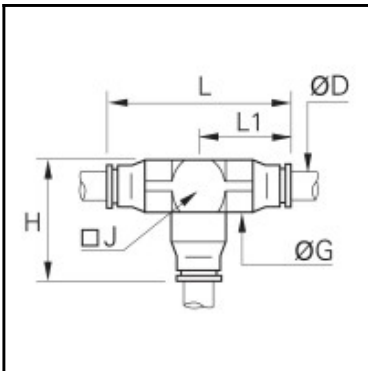

Description

LF 3200 - Miniature-pneumatics, Equal and unequal tee, Brass nickel plated, 3 x 3 mm

Connection at a 90° angle of 3 tubes of equal diameters. Solid construction, compact, aesthetic and unobtrusive for better connection. Full air flow. Individual unit quality control and dating in order to guarantee quality and traceability. Complies RoHS and ISO 14743.

Details

ØD:	3 mm
G:	6
H:	13,5
J:	6
L:	20,5
L1:	10,5
Maximum working pressure in bar:	18
Material seal:	NBR
Material body:	Brass nickel plated
Material release button:	Brass nickel plated
min. temperature in °C:	-15
max. temperature in °C:	70
RoHS compliant:	Yes
Weight in kg:	0,004

Dimensions

ØD:	3 mm
G:	6
H:	13,5
J:	6
L:	20,5
L1:	10,5