

Datasheet of 3188 08 10 T-connection

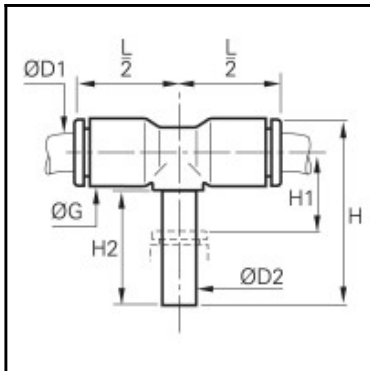

Description

LF 3000 standard pneumatic, T-connection, Engineered polymer, 2 x 8 mm - 10 mm

Connection of 2 tubes at a 90° angle with another push-in fitting or cartridge. compact.solid construction, aesthetic and unobtrusive for a better connection. Full air flow. Individual unit quality control and dating in order to guarantee quality and traceability. Complies RoHS and ISO 14743.

Details

ØD1:	8 mm
ØD2:	10 mm
G:	16
H:	41
H1:	12,5
H2:	24,5
Maximum working pressure in bar:	20
Material seal:	NBR
Material body:	Engineered polymer
Material toothed washer:	Stainless steel
min. temperature in °C:	-20
max. temperature in °C:	80
Vacuum resistance in mm Hg:	755
RoHS compliant:	Yes
Weight in kg:	0,018

Dimensions

ØD1:	8 mm
ØD2:	10 mm
G:	16
H:	41
H1:	12,5
H2:	24,5