

## Datasheet of 3169 08 17 Extended stud elbow

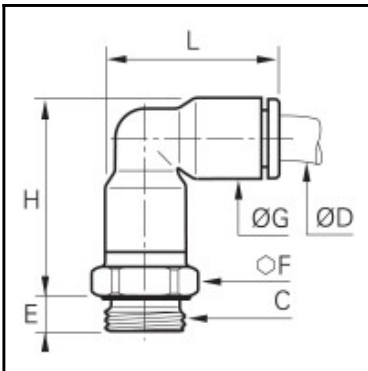

### Description

LF 3000 standard pneumatic, Extended stud elbow, Engineered polymer, 8 mm - G3/8

Connection of tubing at a 90° angle. Dimensions are designed to pass over a 3199 elbow. solid construction, aesthetic and unobtrusive for a better connection. Full air flow. Individual unit quality control and dating in order to guarantee quality and traceability. Complies RoHS.

### Details

ØD:	8 mm
C:	G3/8"
E:	5,5
F:	20
G:	13,5
H:	33
L:	29,5
Maximum working pressure in bar:	20
Material seal:	NBR
Material body:	Engineered polymer
Material threaded fitting:	Brass nickel plated
Material toothed washer:	Stainless steel
min. temperature in °C:	-20
max. temperature in °C:	80
Vacuum resistance in mm Hg:	755
Special feature:	schwenkbar
RoHS compliant:	Yes
Weight in kg:	0,028

### Dimensions

ØD:	8 mm
C:	G3/8"
E:	5,5
F:	20
G:	13,5
H:	33
L:	29,5