

Datasheet of 3101 06 13 Male stud coupling

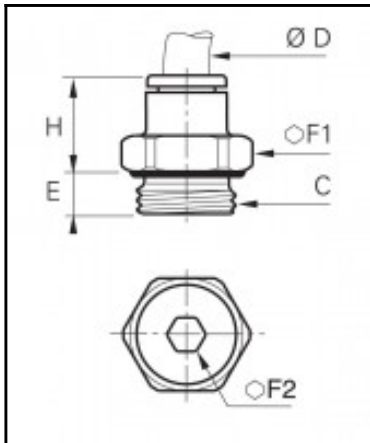

Description

LF 3000 standard pneumatic, male stud coupling, Brass nickel plated, 6 mm - G1/4

In line connection of tubing to a threaded port. External tightening with a flat spanner or Allen key, internal adjustment with an Allen key. Solid construction, compact, aesthetic and unobtrusive for better connection. Full air flow. Individual unit quality control and dating in order to guarantee quality and traceability. Complies RoHS and ISO 14743.

Details

ØD:	6 mm
C:	G1/4"
E:	5,5
F1:	16
F2:	4
H:	12,5
Maximum working pressure in bar:	20
Material seal:	NBR
Material body:	Brass nickel plated
Material toothed washer:	Stainless steel
min. temperature in °C:	-20
max. temperature in °C:	80
Vacuum resistance in mm Hg:	755
RoHS compliant:	Yes
Weight in kg:	0,011

Dimensions

ØD:	6 mm
C:	G1/4"
E:	5,5
F1:	16
F2:	4
H:	12,5