

## Datasheet of FF10021 C Hydraulic plug

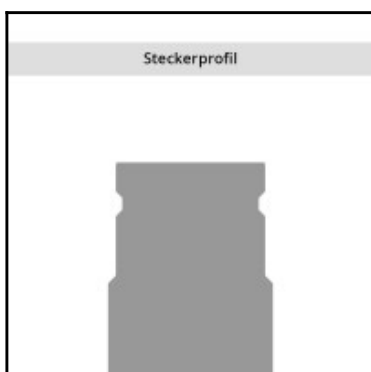
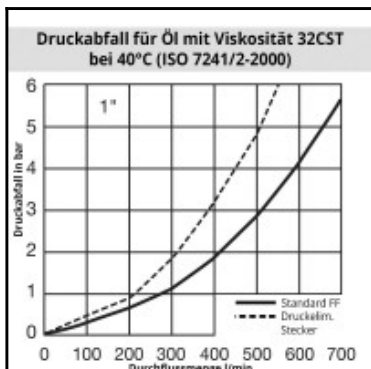
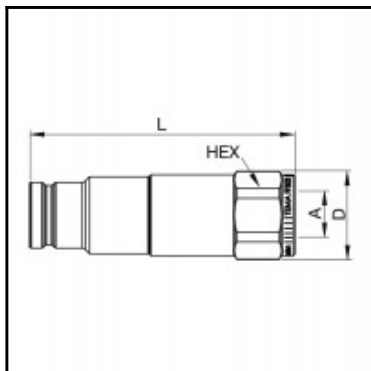

### Description

Hydraulic plug double shut-off with pressure eliminator, female thread G 1, nominal diameter 25,5, 350 bar, steel, seal NBR/PUR

The coupling system of the FF series has double shut-off, dry break and single-handed operation. During disconnection there is no oil loss, and during coupling there is no inclusion of air into the system. Connected length in total FF10010C + FF10020C = 230 mm FF10010C + FF10021C = 269 mm

### Details

Series:	FF
Series long:	FF10000
Bore in mm:	25,5
Bore area in mm²:	510
Size in general:	1"
Advantages:	- Dry break quick connect coupling. - With minimum pressure drop. - Single-handed operation. - No oil loss during disconnection. - A safety closing ring prevents unintentional disconnection. - Twice as safe through double sealing. - Also available with pressure eliminator, i.e. connection is possible under static/residual pressure up to working pressure.
Coupled working pressure in bar:	350
Working temperature:	-20°C up to +100°C (NBR) -25°C up to +200°C (FKM) depending on the medium.
Shut-Off:	Plug Double Shut-Off
Connection:	Female thread 1"
Connection type:	Female thread
Material:	Steel
Surface:	zinc plated, passivated, sealed
Material valve body:	Steel, zinc-plated, passivated, sealed
Material valve:	steel, nitrocarburizing
Material valve holder:	Brass, hard-drawn
Material spring snap ring:	1.4310
Weight in kg:	2,153
Safety locking system:	No
Single-hand operation:	Yes
Two-hand operation:	No
Ball locking:	Yes
Vacuum suitable:	No
Flat-sealing:	No
Pressure eliminator:	Yes
Hydraulics:	Yes

### Dimensions

Connection A:	G 1"
D mm:	60
L mm:	175
SW mm:	55