

Datasheet of FF2510 Quick coupling

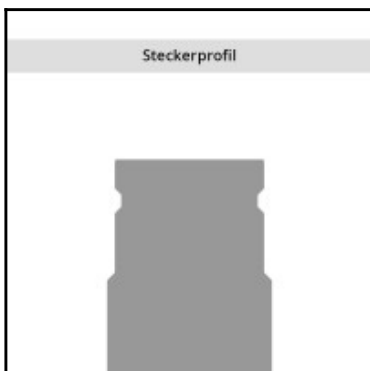
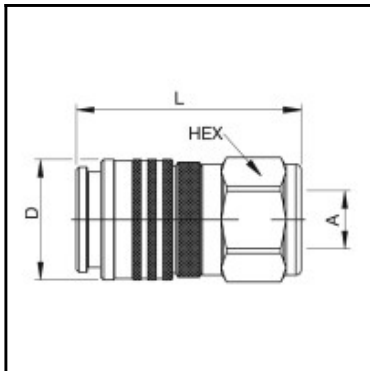

Description

Hydraulic quick coupling double shut-off, female thread G 1/4, nominal diameter 6, 800 bar, steel, seal NBR/PUR

The coupling system of the FF series has double shut-off, dry break and single-handed operation. During disconnection there is no oil loss, and during coupling there is no inclusion of air into the system. Connected length in total FF2510 + FF2520 = 122 mm, FF2510 + FF2521 = 147 mm

Details

Series:	FF
Series long:	FF2500
Bore in mm:	6
Bore area in mm²:	45
Size in general:	1/4"
Advantages:	- Dry break quick connect coupling. - With minimum pressure drop. - Single-handed operation. - No oil loss during disconnection. - A safety closing ring prevents unintentional disconnection. - Twice as safe through double sealing. - Also available with pressure eliminator, i.e. connection is possible under static/residual pressure up to working pressure.
Coupled working pressure in bar:	800
Working temperature:	-20°C up to +100°C (NBR) -25°C up to +200°C (FKM) depending on the medium.
Shut-Off:	Quick coupling Double Shut-Off
Connection:	Female thread 1/4"
Connection type:	Female thread
Material:	Steel
Surface:	nitrocarburizing
Material valve body:	steel, nitrocarburizing
Material sleeve:	Steel hardened, zinc-plated, passivated, sealed
Material locking collar:	Messing, Zink-Eisen beschichtet, schwarz passiviert, versiegelt
Material valve:	Steel hardened, zinc-plated, passivated, sealed
Material valve holder:	Steel, yellow zinc-plated, sealed
Material spring snap ring:	1.4310
Material balls/pins:	1.3541
Weight in kg:	0,28
Safety locking system:	Yes
Single-hand operation:	Yes
Two-hand operation:	No
Ball locking:	Yes
Vacuum suitable:	No
Flat-sealing:	No
Pressure eliminator:	No
Hydraulics:	Yes

Dimensions

Connection A:	G 1/4"
D mm:	30
L mm:	65
SW mm:	27