

Datasheet of 3810 HV Quick coupling

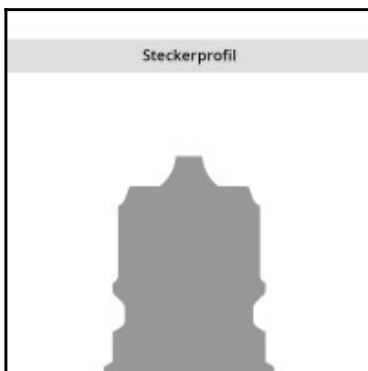
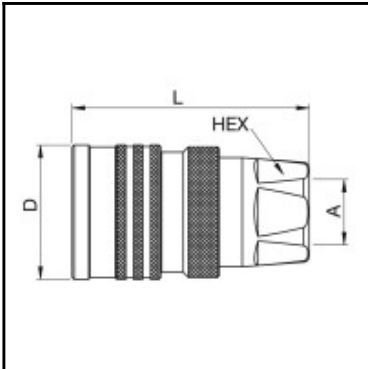

Description

Hydraulic quick coupling straight-through, female thread G 3/8, nominal diameter 10, 350 bar, brass, seal FKM

The TEMA Standard Series is characterised by a low pressure drop and maximum flow capacity. The coupling system is available as double shut-off or straight through version. The 2500 can be used also as a single shut-off version.

Details

Series:	T
Series long:	3800
Bore in mm:	10
Bore area in mm²:	80
Size in general:	3/8"
Advantages:	High operating pressure. Compact dimension. Due to the Pressure Eliminator version for coupling and plug the connection is possible up to the operating pressure. Double safety through a double O-ring seal. A safety closing ring prevents unintentional uncoupling.
Additional information:	high pressure water
Coupled working pressure in bar:	350
Working temperature:	-30°C up to +100°C (NBR) -25°C up to +200°C (FKM) depending on the medium.
Shut-Off:	Quick coupling Straight-Through
Connection:	Female thread 3/8"
Connection type:	Female thread
Material:	Brass
Surface:	chrome plated
Material valve body:	Brass
Material sleeve:	brass, chrome plated
Material spring snap ring:	1.4310
Material balls/pins:	1.3541
Weight in kg:	0,125
Safety locking system:	No
Single-hand operation:	Yes
Two-hand operation:	No
Ball locking:	Yes
Vacuum suitable:	No
Flat-sealing:	No
Pressure eliminator:	No
Hydraulics:	Yes

Dimensions

Connection A:	G 3/8"
D mm:	34
L mm:	60
SW mm:	24