

Datasheet of IF3820 RV Hydraulic plug

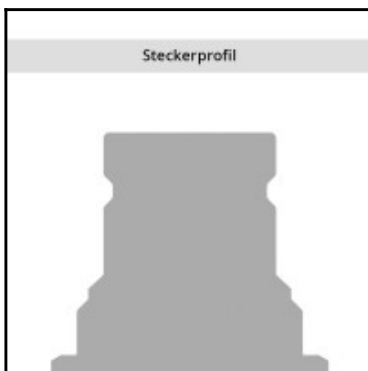
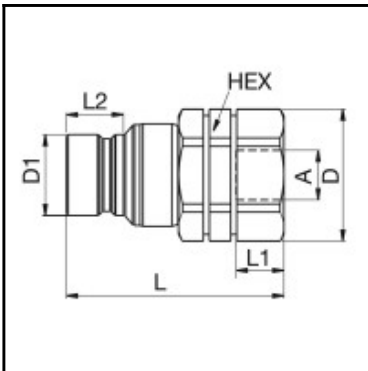

Description

Hydraulic plug double shut-off, female thread G 3/8, nominal diameter 10, 250 bar, stainless steel AISI 316, seal FKM

The FEM, FEC and IF series plug profile are produced according to ISO Standard 16028 and are compatible with other series complying with the same standard. These couplings offer a leakage free disconnection – minimal oil loss during uncoupling. Thanks to the valve design, the coupling has a minimum pressure drop, and thus achieves maximum cost-effectiveness. Exists in standard version (steel) and stainless steel.

Details

| | |
|----------------------------------|---|
| Series: | FEM/IF |
| Series long: | IF3800 |
| Bore in mm: | 10 |
| Bore area in mm²: | 78 |
| Size in general: | 3/8" |
| Advantages: | Can be operated with use of one hand- Safety locking feature as standard to prevent unintentional uncoupling. |
| Coupled working pressure in bar: | 250 |
| Working temperature: | -30°C up to +100°C (NBR) -25°C up to +200°C (FKM) depending on the medium. |
| Shut-Off: | Plug Double Shut-Off |
| Connection: | Female thread 3/8" |
| Connection type: | Female thread |
| Material: | Stainless steel AISI 316 |
| Material valve body: | 1.4401 |
| Material valve: | 1.4401 |
| Material valve holder: | 1.4401 |
| Material spring snap ring: | 1.4310 |
| Weight in kg: | 0,184 |
| Safety locking system: | Yes |
| Single-hand operation: | Yes |
| Two-hand operation: | No |
| Ball locking: | Yes |
| Vacuum suitable: | No |
| Flat-sealing: | No |
| Pressure eliminator: | No |
| Hydraulics: | Yes |

Dimensions

| | |
|---------------|--------|
| Connection A: | G 3/8" |
| D mm: | 32 |
| D1 mm: | 19,7 |
| L mm: | 58 |
| L1 mm: | 12 |
| L2 mm: | 16,1 |
| SW mm: | 30 |