

Datasheet of FEM-621-12FB Quick coupling

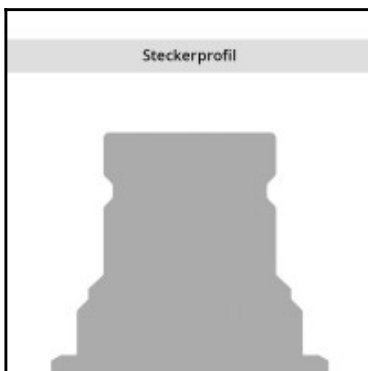
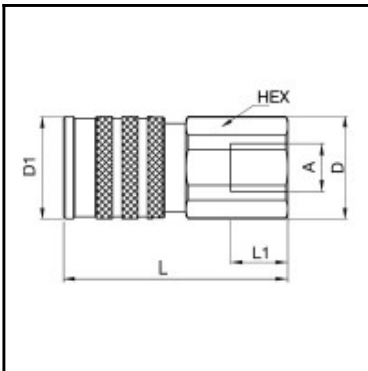

Description

Hydraulic quick coupling double shut-off, female thread G 3/4, nominal diameter 16, 250 bar, steel, seal NBR

The FEM, FEC and IF series plug profile are produced according to ISO Standard 16028 and are compatible with other series complying with the same standard. These couplings offer a leakage free disconnection – minimal oil loss during uncoupling. Thanks to the valve design, the coupling has a minimum pressure drop, and thus achieves maximum cost-effectiveness. Exists in standard version (steel) and stainless steel.

Details

| | |
|----------------------------------|---|
| Series: | FEM/IF |
| Old order number: | IF6310 |
| Series long: | IF6300 |
| Bore in mm: | 16 |
| Bore area in mm²: | 200 |
| Size in general: | 5/8" |
| Advantages: | Can be operated with use of one hand- Safety locking feature as standard to prevent unintentional uncoupling. |
| Coupled working pressure in bar: | 250 |
| Working temperature: | -30°C up to +100°C (NBR) -25°C up to +200°C (FKM) depending on the medium. |
| Shut-Off: | Quick coupling Double Shut-Off |
| Connection: | Female thread 3/4" |
| Connection type: | Female thread |
| Material: | Steel |
| Surface: | zinc plated, passivated, sealed |
| Material valve body: | Steel |
| Material sleeve: | Steel, zinc-plated, passivated, sealed |
| Material valve: | Steel, zinc-plated, passivated, sealed |
| Material valve holder: | Steel, zinc-plated, passivated |
| Material spring snap ring: | 1.4310 |
| Material balls/pins: | 1.3541 |
| Weight in kg: | 0,62 |
| Safety locking system: | Yes |
| Single-hand operation: | Yes |
| Two-hand operation: | No |
| Ball locking: | Yes |
| Vacuum suitable: | No |
| Flat-sealing: | No |
| Pressure eliminator: | No |
| Hydraulics: | Yes |

Dimensions

| | |
|---------------|--------|
| Connection A: | G 3/4" |
| D mm: | 43 |
| D1 mm: | 42 |
| L mm: | 82 |
| L1 mm: | 16 |
| SW mm: | 40 |