

## Datasheet of IB2521 V Hydraulic plug

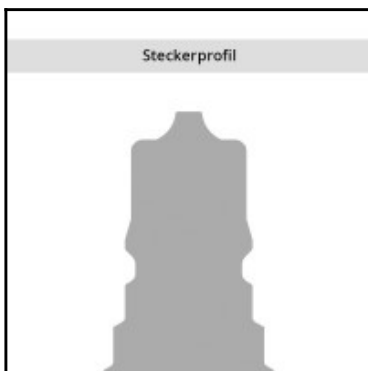
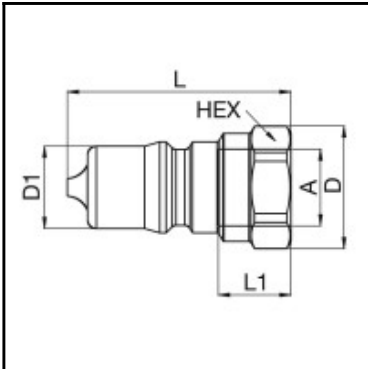

### Description

Hydraulic plug double shut-off with pressure eliminator, female thread G 1/4, nominal diameter 6,3, 400 bar, steel, seal FKM

The Tema IB series plug profiles conform to ISO Standard 7241-1 series B and are compatible with other series complying with the same standard. To optimize performance and corrosion resistance the female is made from brass and the male hardened steel.

### Details

Series:	IB
Series long:	IB2500
Bore in mm:	6,3
Bore area in mm²:	31
Size in general:	1/4"
Advantages:	ISO-NormseriesB
Coupled working pressure in bar:	400
Working temperature:	-30°C up to +100°C (NBR) -25°C up to +200°C (FKM) depending on the medium.
Shut-Off:	Plug Double Shut-Off
Connection:	Female thread 1/4"
Connection type:	Female thread
Material:	Steel
Surface:	zinc plated, passivated, sealed
Material valve body:	steel hardened
Material valve:	Brass
Material valve holder:	Brass
Material spring snap ring:	1.4310
Weight in kg:	0,036
Safety locking system:	No
Single-hand operation:	No
Two-hand operation:	Yes
Ball locking:	Yes
Vacuum suitable:	No
Flat-sealing:	No
Pressure eliminator:	Yes
Hydraulics:	Yes

### Dimensions

Connection A:	G 1/4"
D mm:	21
D1 mm:	14,1
L mm:	38
L1 mm:	12
SW mm:	19