

Datasheet of IB3820 Hydraulic plug

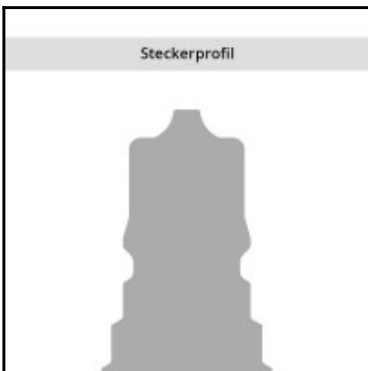
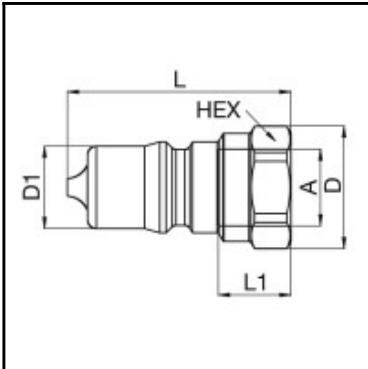

Description

Hydraulic plug double shut-off, female thread G 3/8, nominal diameter 10, 320 bar, steel, seal NBR

The Tema IB series plug profiles conform to ISO Standard 7241-1 series B and are compatible with other series complying with the same standard. To optimize performance and corrosion resistance the female is made from brass and the male hardened steel.

Details

| | |
|----------------------------------|--|
| Series: | IB |
| Series long: | IB3800 |
| Bore in mm: | 10 |
| Bore area in mm²: | 78 |
| Size in general: | 3/8" |
| Advantages: | ISO-NormseriesB |
| Coupled working pressure in bar: | 320 |
| Working temperature: | -30°C up to +100°C (NBR) -25°C up to +200°C (FKM) depending on the medium. |
| Shut-Off: | Plug Double Shut-Off |
| Connection: | Female thread 3/8" |
| Connection type: | Female thread |
| Material: | Steel |
| Surface: | zinc plated, passivated, sealed |
| Material valve body: | steel hardened |
| Material valve: | Brass |
| Material valve holder: | Zinc cast |
| Material spring snap ring: | 1.4310 |
| Weight in kg: | 0,053 |
| Safety locking system: | No |
| Single-hand operation: | No |
| Two-hand operation: | Yes |
| Ball locking: | Yes |
| Vacuum suitable: | No |
| Flat-sealing: | No |
| Pressure eliminator: | No |
| Hydraulics: | Yes |

Dimensions

| | |
|---------------|--------|
| Connection A: | G 3/8" |
| D mm: | 24 |
| D1 mm: | 19 |
| L mm: | 42 |
| L1 mm: | 12 |
| SW mm: | 22 |