

Datasheet of 750 RF Swivel joint

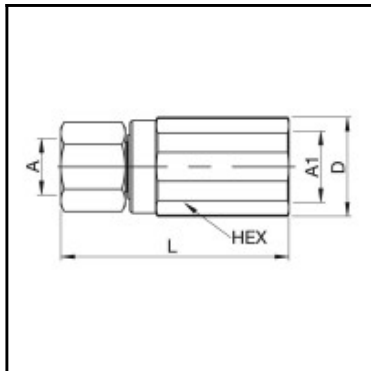

Description

Swivel joint female thread G 3/4 auf G 1, max. 250 bar

Can be used in hydraulic systems where rotating connections are essential, for example on accessories with rotating movements. Depending on design, the body is made of brass (DG) or steel (KR) and the rotating axis of surfacepurified/stainless steel. Maximum rotation speed: 60 r.p.m.

Details

Series:	DG
Series long:	DG
Maximum working pressure in bar:	250
Advantages:	Rotating joints minimise the high wear to the hose, which occurs in hydraulic systems. Solid construction with two plain bearings (DG) or ball/ roller bearings (KR). Suitable for combining with norm hydraulic components.
Additional information:	Shaft made of stainless steel
Working temperature:	-40°C up to +90°C (NBR) depending on the medium.
Connection type:	Female thread
Material body:	Brass
Material axis of rotation:	Stainless steel
Material nut/adapter:	Steel, zinc-plated, passivated, sealed
Weight in kg:	0,45
Hydraulics:	Yes

Dimensions

Connection A:	G 3/4"
Connection A1:	G 1"
D mm:	35
L mm:	80
SW mm:	40