

## Datasheet of 51SFAW13SXN Plug with male thread

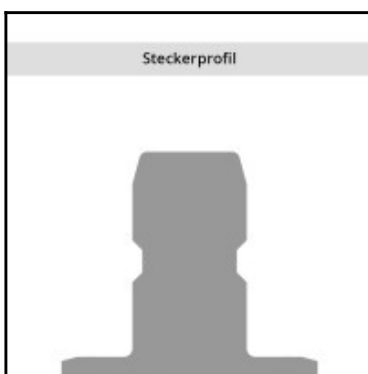
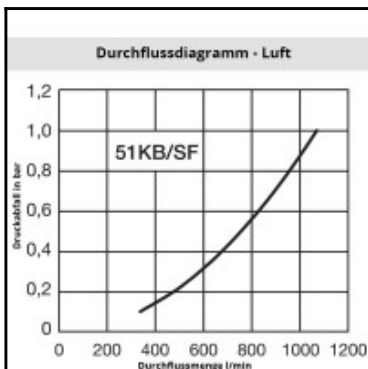
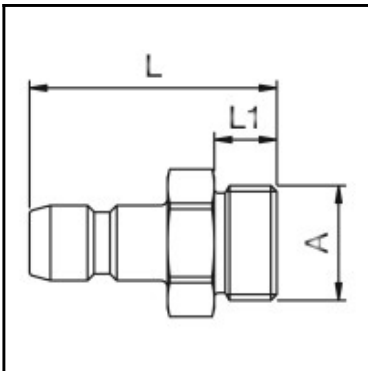

### Description

Plug straight-through, male thread G 1/4, nominal diameter 6, <50 bar, steel nickel plated

Coupling system with German industrial profile. Coupling system with single-hand operation. UltraFlo valve for optimum flow and low pressure drop. Robust coupling in slim design mainly for pneumatic applications. The steel sleeve counters oscillating forces. The high insertion depth is guaranteed by an optimised plug guide.

### Details

Series:	51
Series long:	51SF
Bore in mm:	6
Bore area in mm²:	30
Advantages:	Single handed operation. Ergonomic design. High flow valve.
Working pressure:	PB = 50 bar maximum static working pressure with safety factor 4 to 1.
Working temperature:	-20°C up to +100°C (NBR) -40°C up to +120/150°C (EPDM) -15°C up to +200°C (FKM) depending on the medium.
Shut-Off:	Plug Straight-Through
Connection:	Male thread 1/4"
Connection description:	Male pipe thread of Whitworth form ISO 228 1/4"
Connection type:	Male thread
Material:	Steel nickel-plated
Material description:	Steel 9SMnPb28K 1.0718
Surface:	nickel plated
Weight in kg:	0,0247
Self-venting coupling:	No
Safety locking system:	No
Single-hand operation:	Yes
Two-hand operation:	No
Ball locking:	No
Pin lock:	No
Ultra-FLO-valve:	No
Vacuum suitable:	Yes
Water-resistant:	No
Flat-sealing:	No
Suitable breath / respiratory protection:	No
Pressure eliminator:	No
Hydraulics:	No
Pneumatics:	Yes
Standard product:	No
Mould coupling:	No

### Dimensions

Connection A:	G 1/4
L mm:	35
L1 mm:	9
SW mm:	17