

## Datasheet of TI13E Tee female thread



### Description

Tee female thread, stainless steel AISI 316, G 1/4

Tee female thread - stainless steel AISI 316 - G 1/4

### Details

Material:	Stainless steel AISI 316
Working pressure:	0 up to 70 bar
Working temperature:	-40°C up to +200°C
Weight in kg:	0,052

### Dimensions

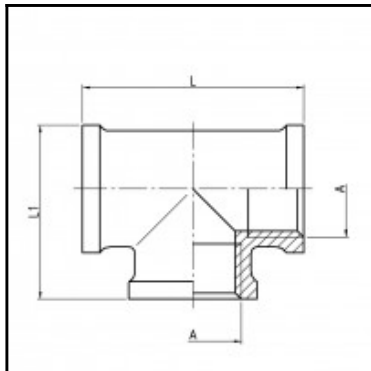

Connection 1:	Female thread G 1/4"
Connection 2:	Female thread G 1/4"
Connection A:	G 1/4
L mm:	33
L1 mm:	25