

Datasheet of TI10E Tee female thread



Description

Tee female thread, stainless steel AISI 316, G 1/8

Tee female thread - stainless steel AISI 316 - G 1/8

Details

Material:	Stainless steel AISI 316
Working pressure:	0 up to 70 bar
Working temperature:	-40°C up to +200°C
Weight in kg:	0,046

Dimensions

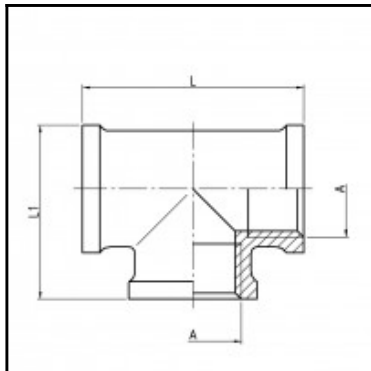

Connection 1:	Female thread G 1/8"
Connection 2:	Female thread G 1/8"
Connection A:	G 1/8
L mm:	30
L1 mm:	22