

Datasheet of EV17/12FX09 Hose fitting



Description

Hose fitting, PVDF, G 3/8, 9 x 12 mm

Hose fitting - PVDF - G 3/8, 9 x 12 mm

Details

Material:	PVDF
Working pressure:	0 up to 8 bar
Working temperature:	-20°C up to +120°C
Additional information:	for hard plastic hoses in PVDF or PE
Weight in kg:	0,016

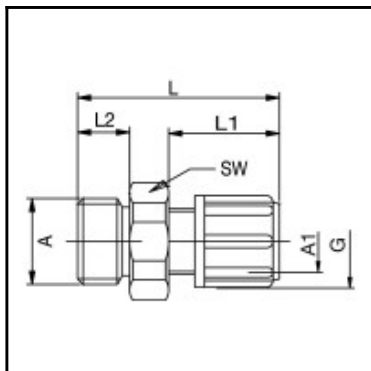

Dimensions

Connection 1:	Male thread G 3/8"
Connection 2:	Hose fitting 9 x 12 mm
Connection A:	G 3/8
Connection A1:	9 x 12
G mm:	M 12x1
L mm:	45
L1 mm:	28
L2 mm:	9
SW mm:	22