

Datasheet of EV13/08FX Plastic screw connector



Description

Plastic screw connector, PVDF, G 1/4, 6 x 8 mm

Plastic screw connector - PVDF - G 1/4, 6 x 8 mm

Details

Material:	PVDF
Working pressure:	0 up to 8 bar
Working temperature:	-20°C up to +120°C
Weight in kg:	0,004

Dimensions

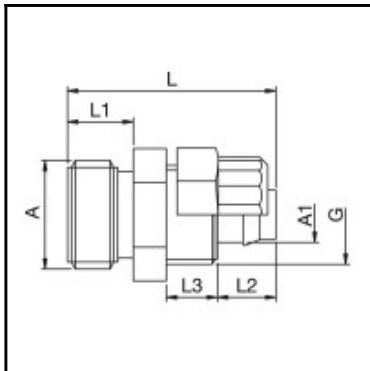

Connection 1:	Male thread G 1/4"
Connection 2:	Hose fitting 6 x 8 mm
Connection A:	G 1/4
Connection A1:	6 x 8
G mm:	M 12x1
L mm:	25
L1 mm:	8
L2 mm:	13
SW mm:	14