

Datasheet of EV13/06FX04 Hose fitting



Description

Hose fitting, PVDF, G 1/4, 4 x 6 mm

Hose fitting - PVDF - G 1/4, 4 x 6 mm

Details

Material:	PVDF
Working pressure:	0 up to 8 bar
Working temperature:	-20°C up to +120°C
Additional information:	for hard plastic hoses in PVDF or PE
Weight in kg:	0,0055

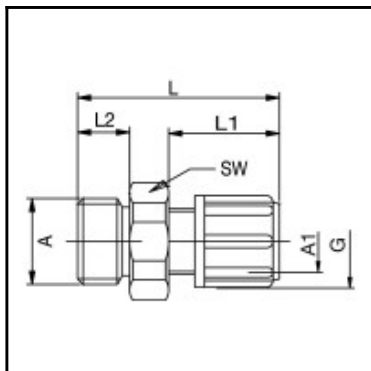

Dimensions

Connection 1:	Male thread G 1/4"
Connection 2:	Hose fitting 4 x 6 mm
Connection A:	G 1/4
Connection A1:	4 x 6
G mm:	M 10x1
L mm:	31
L1 mm:	17
L2 mm:	8
SW mm:	17