

Datasheet of KM26WN Bulkhead lock nut



Description

Bulkhead lock nut, brass nickel plated, G 3/4

Bulkhead lock nut - brass nickel plated - G 3/4

Details

Material:	Brass nickel plated
Working pressure:	0 up to 70 bar
Working temperature:	-40°C up to +200°C
Weight in kg:	0,0172

Dimensions

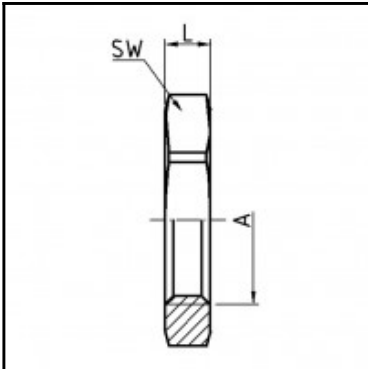

Connection 1:	Female thread G 3/4"
Connection 2:	Female thread G 3/4"
Connection A:	G 3/4
L mm:	8
SW mm:	30