

Datasheet of KM21WN Bulkhead lock nut



Description

Bulkhead lock nut, brass nickel plated, G 1/2

Bulkhead lock nut - brass nickel plated - G 1/2

Details

Material:	Brass nickel plated
Working pressure:	0 up to 70 bar
Working temperature:	-40°C up to +200°C
Weight in kg:	0,0128

Dimensions

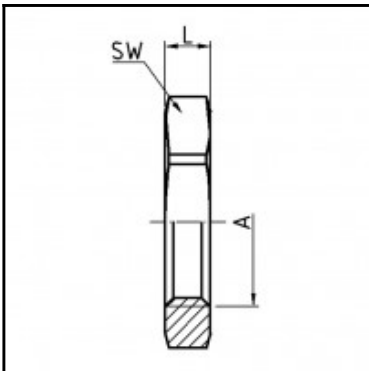

Connection 1:	Female thread G 1/2"
Connection 2:	Female thread G 1/2"
Connection A:	G 1/2
L mm:	5
SW mm:	27