

## Datasheet of KM10W Bulkhead lock nut



### Description

Bulkhead lock nut, brass, G 1/8

Bulkhead lock nut - brass - G 1/8

### Details

Material:	Brass
Working pressure:	0 up to 70 bar
Working temperature:	-40°C up to +200°C
Weight in kg:	0,0035

### Dimensions

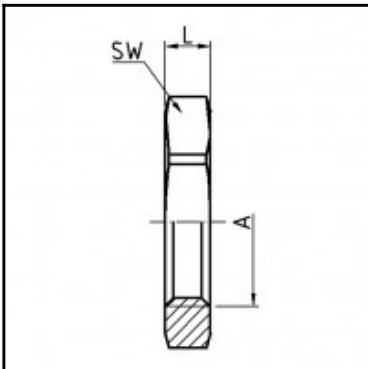

Connection 1:	Female thread G 1/8"
Connection 2:	Female thread G 1/8"
Connection A:	G 1/8
L mm:	3,5
SW mm:	15