

Datasheet of LD26/26KN Adjustable nipple



Description

Male x male nipple adjustable, brass nickel plated, R 3/4 x R 3/4

Male x male nipple adjustable - brass nickel plated - R 3/4 x R 3/4

Details

Material:	Brass nickel plated
Working pressure:	0 up to 70 bar
Working temperature:	-40°C up to +200°C
Weight in kg:	0,1996

Dimensions

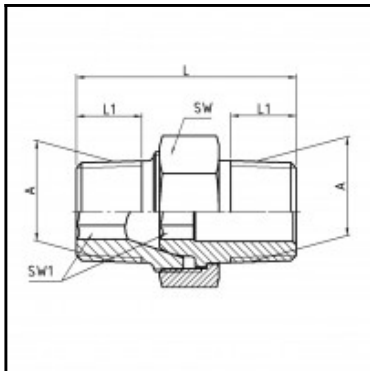

Connection 1:	Male thread R 3/4"
Connection 2:	Male thread R 3/4"
Connection A:	R 3/4
L mm:	53
L1 mm:	19
SW mm:	36
SW1 mm:	14