

Datasheet of DN17/17V Double nipple



Description

Male x male nipple, brass, G 3/8 x G 3/8 verl.

Male x male nipple - brass - G 3/8 x G 3/8 verl.

Details

Material:	Brass
Working pressure:	0 up to 70 bar
Working temperature:	-40°C up to +200°C
Special feature:	with inner cone 45°, only usable with DIN threaded nut UR17
Weight in kg:	0,0258

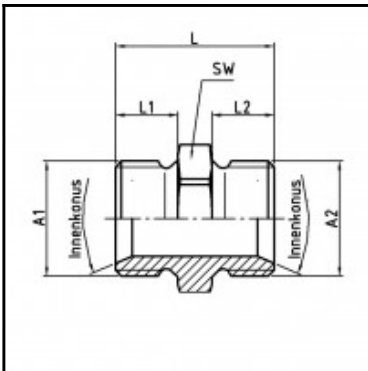

Dimensions

Connection 1:	Male thread G 3/8"
Connection 2:	Male thread G 3/8"
Connection A1:	G 3/8
Connection A2:	G 3/8
L mm:	27
L1 mm:	11
L2 mm:	11
SW mm:	19