

Datasheet of DN10/13N Double nipple



Description

Male x male nipple, brass nickel plated, G 1/8 x G 1/4

Male x male nipple - brass nickel plated - G 1/8 x G 1/4

Details

Material:	Brass nickel plated
Working pressure:	0 up to 70 bar
Working temperature:	-40°C up to +200°C
Special feature:	with inner cone 45°
Weight in kg:	0,016

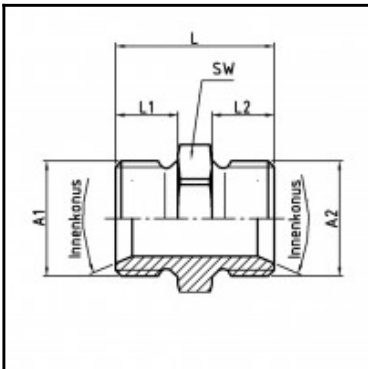

Dimensions

Connection 1:	Male thread G 1/8"
Connection 2:	Male thread G 1/4"
Connection A1:	G 1/8
Connection A2:	G 1/4
L mm:	20
L1 mm:	7
L2 mm:	9
SW mm:	17