

Datasheet of 95SSTF09MXN Plug with hose barb

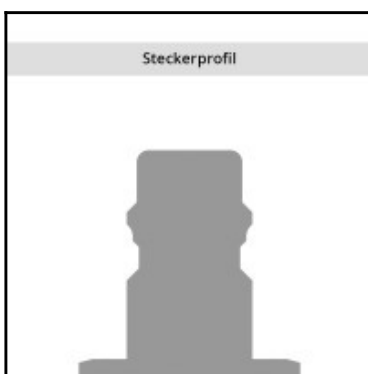
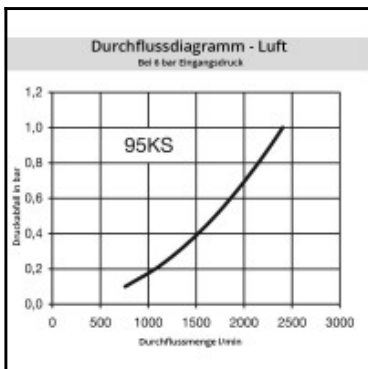
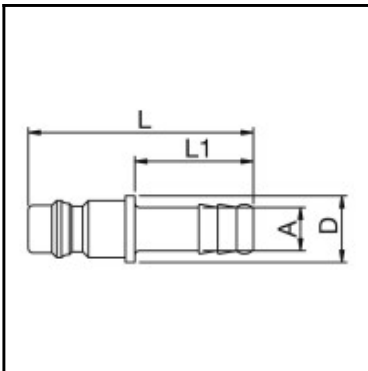

Description

Plug safety straight through, hose barb 9mm (3/8), nominal diameter 7,4, <35 bar, brass nickel plated

This coupling system has been developed specifically for the area of breathing protection. Coupling system with single-hand operation. UltraFlo valve for optimum flow and low pressure drop. Additional safety locking system. This safety lock prevents unintentional disconnection. To disconnect, the plug must first be pushed further into the coupling before it can be unlocked. Profile cannot be interconnected with the 96KS series. Tested according to EN 139 standard.

Details

Series:	95
Series long:	95SS
Bore in mm:	7,4
Bore area in mm²:	43
Advantages:	Additional safety locking system.
Working pressure:	35 bar maximum static working pressure with safety factor 4 to 1.
Working temperature:	-20°C up to +100°C (NBR) -40°C up to +120/150°C (EPDM) -15°C up to +200°C (FKM) 0°C up to +316°C (FFKM) depending on the medium.
Shut-Off:	Plug Safety (straight-through)
Connection:	Hose barb 9mm LW(3/8")
Connection description:	Hose barb 9mm LW(3/8")
Connection type:	Hose barb
Material:	Brass nickel plated
Material description:	Brass CuZn39Pb3 2.0401 (except sleeve)
Surface:	nickel plated
Weight in kg:	0,0175
Self-venting coupling:	No
Safety locking system:	Yes
Single-hand operation:	No
Two-hand operation:	Yes
Ball locking:	No
Pin lock:	No
Ultra-FLO-valve:	No
Vacuum suitable:	Yes
Water-resistant:	No
Flat-sealing:	No
Suitable breath / respiratory protection:	Yes
Pressure eliminator:	No
Hydraulics:	No
Pneumatics:	Yes
Standard product:	No
Mould coupling:	No

Dimensions

Connection A:	9 mm
D mm:	14
L mm:	47,5
L1 mm:	25