

Datasheet of 48SFAW13FXX Plug with male thread

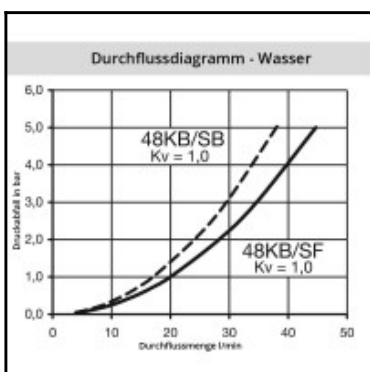
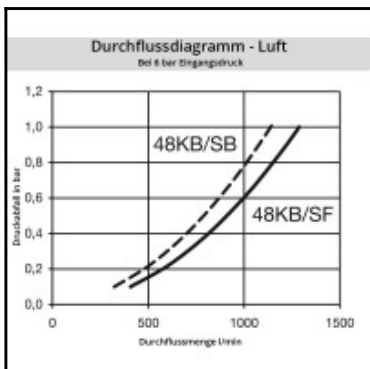
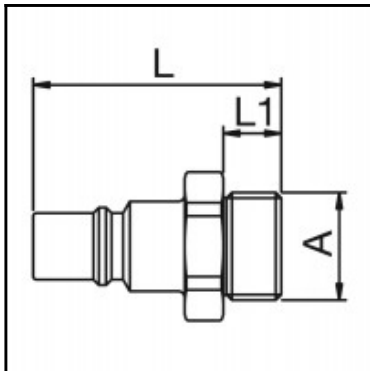

Description

Plug straight-through, male thread G 1/4, nominal diameter 7, <8 bar, PVDF

Coupling series made of POM and PVDF has been developed for use in the medical, chemical, food handling, pharmaceutical and laboratory technology industries. The system is also available in a solid plastic design (RectuChem+). Here the metal springs are replaced by springs made of PEEK, an extremely resistant synthetic material.

Details

| | |
|---|---|
| Series: | 48 |
| Series long: | 48SF |
| Bore in mm: | 7 |
| Bore area in mm²: | 38 |
| Advantages: | Coupling system with single-hand operation. The color coding of the coupling and plug offers a guarantee for avoiding mix-ups between media when coupling. The coupling is also available with no valve for a straightthrough system. |
| Working pressure: | PB = 8 bar (PVDF with springs made of steel) PB = 8 bar (PVDF with springs made of PEEK), maximum static working pressure with safety factor 4 to 1. |
| Working temperature: | -20°C up to +120°C depending on the medium. |
| Shut-Off: | Plug Straight-Through |
| Connection: | Male thread 1/4" |
| Connection description: | Male pipe thread of Whitworth form ISO 228 1/4" |
| Connection type: | Male thread |
| Material: | PVDF |
| Material description: | PVDF |
| Surface: | blank finish |
| Weight in kg: | 0,007 |
| Self-venting coupling: | No |
| Safety locking system: | No |
| Single-hand operation: | Yes |
| Two-hand operation: | No |
| Ball locking: | No |
| Pin lock: | No |
| Ultra-FLO-valve: | No |
| Vacuum suitable: | Yes |
| Water-resistant: | Yes |
| Flat-sealing: | No |
| Suitable breath / respiratory protection: | No |
| Pressure eliminator: | No |
| Hydraulics: | No |
| Pneumatics: | Yes |
| Standard product: | No |
| Mould coupling: | No |

Dimensions

| | |
|---------------|-------|
| Connection A: | G 1/4 |
| L mm: | 38,5 |
| L1 mm: | 9 |
| SW mm: | 17 |