

## Datasheet of 6016SFAK26SXZ Plug with male thread

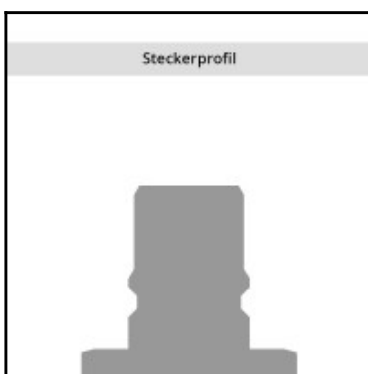
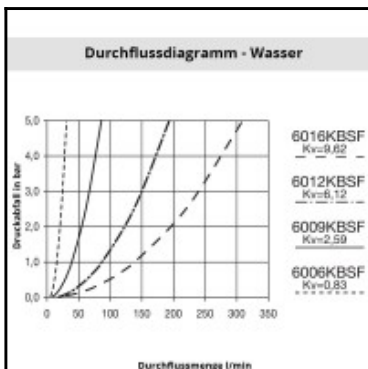
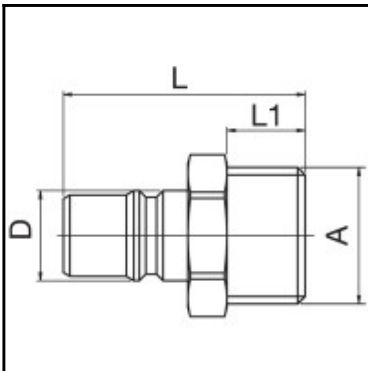

### Description

Plug straight-through, male thread R 3/4, nominal diameter 16, <20 bar, steel zinc plated

This range of couplings was constructed with valves as an alternative to the French profiles. All four nominal diameters in our Frenchmatic I range are available with single and double shut-off.

### Details

Series:	6016
Series long:	6016SF
Bore in mm:	16
Bore area in mm²:	200
Advantages:	The locking balls guarantee an optimum hold by the insert connection even with forces acting from the side. Optimum flow rate with absolute minimal flow resistance.
Working pressure:	PB = 20 bar, maximum static working pressure with safety factor of 4 to 1.
Working temperature:	-15°C up to +200°C (FKM) depending on the medium
Shut-Off:	Plug Straight-Through
Connection:	Male thread 3/4"
Connection description:	Male tapered thread of Whitworth form DIN 2999 3/4
Connection type:	Male thread
Material:	Galvanized steel
Material description:	Steel 9SMnPb28K 1.0718
Surface:	zinc plated
Weight in kg:	0,0959
Self-venting coupling:	No
Safety locking system:	No
Single-hand operation:	Yes
Two-hand operation:	No
Ball locking:	No
Pin lock:	No
Ultra-FLO-valve:	No
Vacuum suitable:	Yes
Water-resistant:	Yes
Flat-sealing:	No
Suitable breath / respiratory protection:	No
Pressure eliminator:	No
Hydraulics:	No
Pneumatics:	No
Standard product:	No
Mould coupling:	Yes

### Dimensions

Connection A:	R 3/4
D mm:	22,4
L mm:	59
L1 mm:	19
SW mm:	27