

## Datasheet of TA38 Pressure release valve

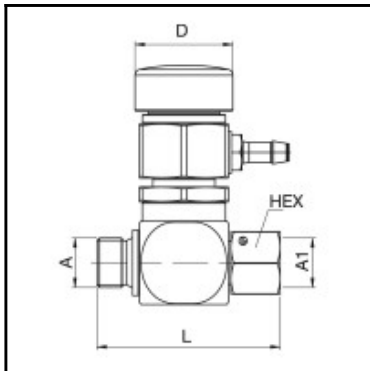
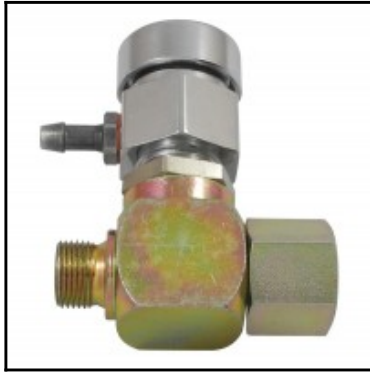

### Description

Pressure release valve female-/male thread G 3/8, max. 250 bar

Produced for hydraulic systems where in line quick connect couplings are used. The system pressure built up between the hydraulic unit and the coupling would not allow mechanical coupling.

### Details

Series:	DEV
Series long:	DEV
Maximum working pressure in bar:	250
Advantages:	The Pressure Relief Valve can be mounted directly in the main inflow line so that all downstream pipe or hose lines where quick connect couplings or plugs are installed at the ends can be depressurised.
Working pressure:	max. 250 bar
Working temperature:	up to max. +90°C depending on the medium.
Connection type:	Female / Male thread
Material T-distributor:	Steel, zinc-plated, passivated, sealed
Weight in kg:	0,463
Hydraulics:	Yes

### Dimensions

Connection A:	G 3/8"
Connection A1:	G 3/8"
D mm:	33
L mm:	62
SW mm:	21