

## Datasheet of 23KAKO10MPN Quick coupling with male thread

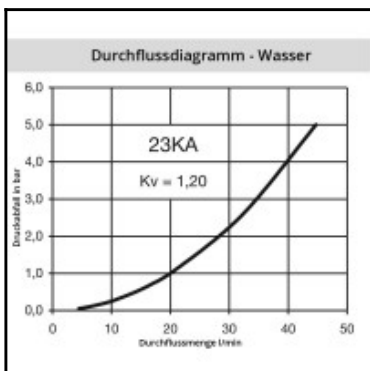
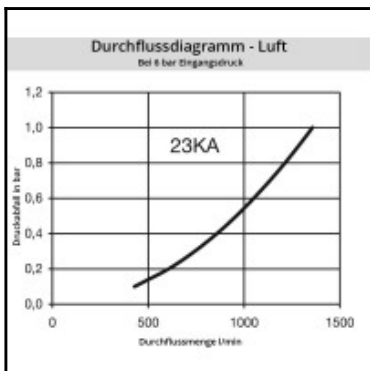
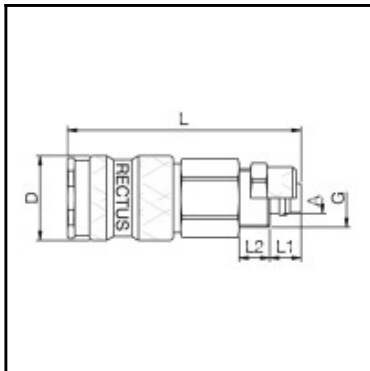

### Description

Quick coupling single shut-off, with hose nut 8 x 10 mm, nominal diameter 5,5, <35 bar, brass nickel plated, seal NBR

1/4 industrial coupling according to ISO 6150 B and US MIL-SPEC 4109. Especially suitable for use with gaseous media in industry. Coupling system with single-hand operation. UltraFlo valve for optimum flow and low pressure drop. Steel sleeve counters oscillating forces. The high insertion depth is guaranteed by an optimised plug guide.

### Details

Series:	23
Series long:	23KA
Bore in mm:	5,5
Bore area in mm²:	25
Advantages:	One-hand operation. The high insertion depth is guaranteed by an optimised plug guide. UltraFlo valve.
Compatibility:	INDUSTR. INTERCHANGE 1/4" US-MIL-SPEC-C-4109 ISO 6150 RECTUS 24, RECTUS 1400/1423 TEMA 1400 PARKER 20 1/4" + 30 1/4"
Working pressure:	35 bar maximum static working pressure with safety factor 4 to 1.
Working temperature:	-20°C up to +100°C (NBR) -40°C up to +120/150°C (EPDM) -15°C up to +200°C (FKM) depending on the medium.
Shut-Off:	Quick coupling Single Shut-Off
Connection:	with tube nut 8 x 10 mm
Connection description:	with tube nut 8 x 10 mm
Connection type:	Connection nut
Material:	Brass nickel plated
Material description:	Brass CuZn39Pb3 2.0401 (except sleeve)
Seal description:	Nitrite-butadiene rubber
Surface:	nickel plated
Material connection:	Brass nickel plated
Material valve body:	Brass nickel plated
Material sleeve:	Steel hardened and nickel plated
Material valve:	Zinc diecasting nickel plated
Material spring snap ring:	stainless steel AISI 301
Material balls/pins:	Stainless steel AISI 420
Material seal:	Perbunan®
Weight in kg:	0,11
Self-venting coupling:	No
Safety locking system:	No
Single-hand operation:	Yes
Two-hand operation:	No
Ball locking:	Yes
Pin lock:	No
Ultra-FLO-valve:	No
Vacuum suitable:	Yes
Water-resistant:	No
Flat-sealing:	No
Suitable breath / respiratory protection:	No
Pressure eliminator:	No
Hydraulics:	No
Pneumatics:	Yes
Standard product:	No
Mould coupling:	No

### Dimensions

Connection A:	8 x 10 mm
D mm:	23
G mm:	M 16 x 1
L mm:	64
L1 mm:	9
L2 mm:	8
SW mm:	19