

Datasheet of 72KBIW13DEX Quick coupling with female thread

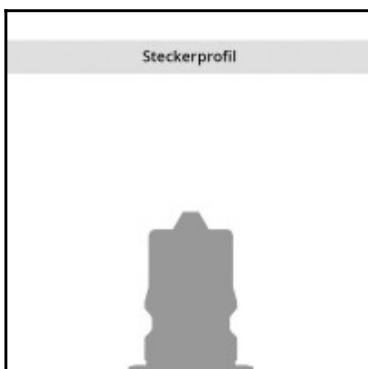
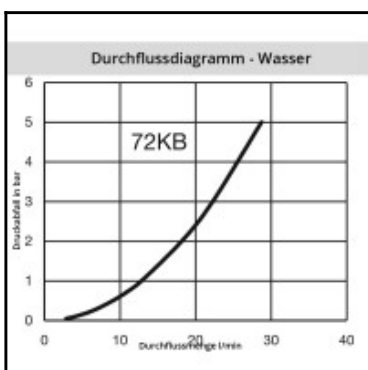
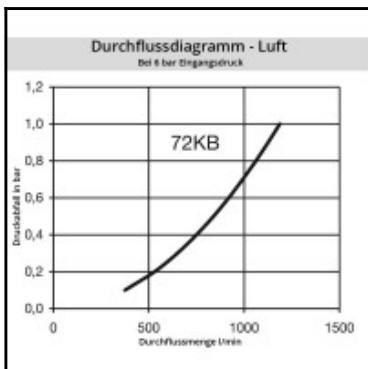
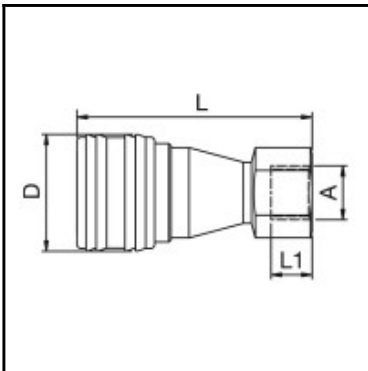

Description

Quick coupling double shut-off, female thread G 1/4, nominal diameter 6,3, <15 bar, POM (Delrin), seal EPDM

Coupling series 72kb with plug profile compliant with ISO 7241-1 series B. Particularly suited to use with liquid medio. Coupling system with two-hand operation, i.e. both hands are required when coupling/uncoupling. The coupling series stands out for its high flow rates against a low pressure drop.

Details

| | |
|---|--|
| Series: | 72 |
| Series long: | 72KB |
| Bore in mm: | 6,3 |
| Bore area in mm²: | 31 |
| Advantages: | Particularly suited to use with liquid medio. |
| Working pressure: | PB = 15 bar (at 50°C), maximum static working pressure with safety factor 4 to 1. |
| Working temperature: | -20°C up to +90°C (NBR) -40°C up to +90°C (EPDM) -15°C up to +90°C (FKM) depending on the medium. |
| Shut-Off: | Quick coupling Double Shut-Off |
| Connection: | Female thread 1/4" |
| Connection description: | Female pipe thread of Whitworth form ISO 228 1/4" |
| Connection type: | Female thread |
| Material: | POM (Delrin) |
| Material description: | POM (Delrin) |
| Seal description: | Ethylene-propylene-diene rubber |
| Surface: | blank finish |
| Material connection: | POM, white |
| Material valve body: | POM, white |
| Material sleeve: | POM, white |
| Material valve: | stainless steel AISI 303 |
| Material spring snap ring: | stainless steel AISI 301 |
| Material balls/pins: | Stainless steel AISI 316 |
| Weight in kg: | 0,031 |
| Self-venting coupling: | No |
| Safety locking system: | No |
| Single-hand operation: | No |
| Two-hand operation: | Yes |
| Ball locking: | Yes |
| Pin lock: | No |
| Ultra-FLO-valve: | No |
| Vacuum suitable: | Yes |
| Water-resistant: | Yes |
| Flat-sealing: | No |
| Suitable breath / respiratory protection: | Yes |
| Pressure eliminator: | No |
| Hydraulics: | No |
| Pneumatics: | Yes |
| Standard product: | Yes |
| Mould coupling: | Yes |

Dimensions

| | |
|---------------|-------|
| Connection A: | G 1/4 |
| D mm: | 28,5 |
| L mm: | 57,5 |
| L1 mm: | 10 |
| SW mm: | 19 |