

Datasheet of 39SLTF19MPN Plug with hose barb

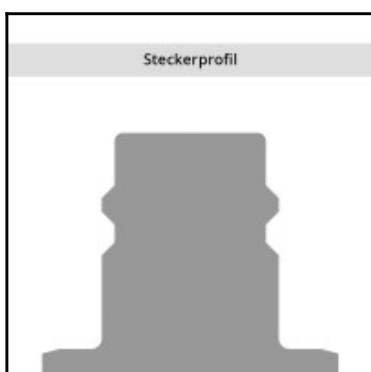
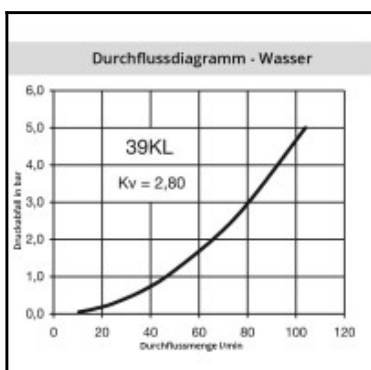
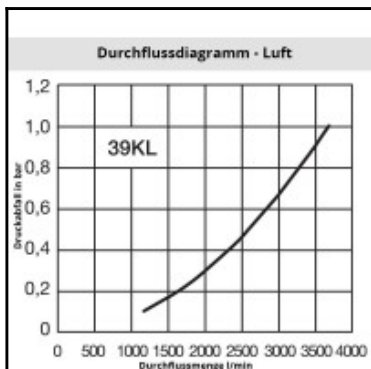
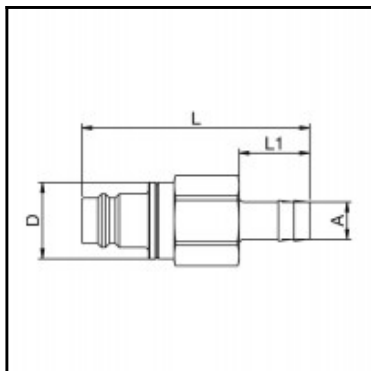

Description

Plug dry-break double shut-off, hose barb 19mm (3/4), nominal diameter 19, <35 bar, brass nickel plated, seal NBR

Compact industrial coupling system in brass for use with numerous gaseous and liquid media. UltraFlo valve for optimum flow and low pressure drop.

Details

Series:	39
Series long:	39SL
Bore in mm:	19
Bore area in mm²:	300
Advantages:	Compact design. Extremely high flow rate. UltraFlo valve.
Working pressure:	35 bar maximum static working pressure with safety factor 4 to 1.
Working temperature:	-20°C up to +100°C (NBR) -40°C up to +120/150°C (EPDM) -15°C up to +200°C (FKM) 0°C up to +316°C (FFKM) depending on the medium.
Shut-Off:	Plug Dry-Break (double shut-off)
Connection:	Hose barb 19mm LW(3/4")
Connection description:	Hose barb 19mm LW(3/4")
Connection type:	Hose barb
Material:	Brass nickel plated
Material description:	Brass CuZn39Pb3 2.0401 (except sleeve)
Seal description:	Nitrile-butadiene rubber
Surface:	nickel plated
Material connection:	Brass nickel plated
Material valve:	Brass
Material spring snap ring:	stainless steel AISI 301
Material seal:	Perbunan®
Weight in kg:	0,4331
Self-venting coupling:	No
Safety locking system:	No
Single-hand operation:	Yes
Two-hand operation:	No
Ball locking:	No
Pin lock:	No
Ultra-FLO-valve:	No
Vacuum suitable:	Yes
Water-resistant:	Yes
Flat-sealing:	No
Suitable breath / respiratory protection:	No
Pressure eliminator:	No
Hydraulics:	No
Pneumatics:	Yes
Standard product:	No
Mould coupling:	No

Dimensions

Connection A:	19 mm
L mm:	114
L1 mm:	36
SW mm:	41