

Datasheet of 39SFTF25MXX Plug with hose barb

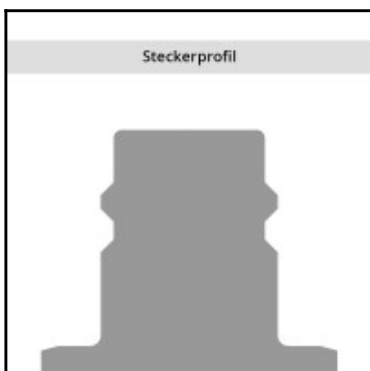
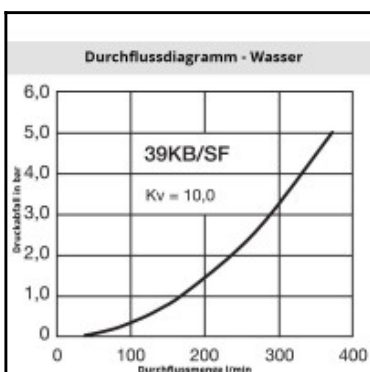
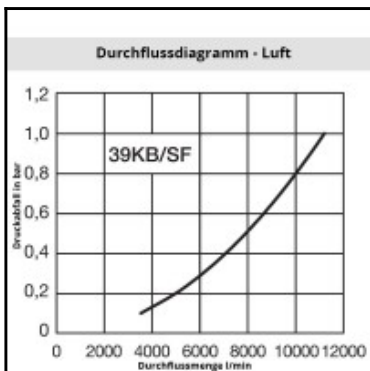
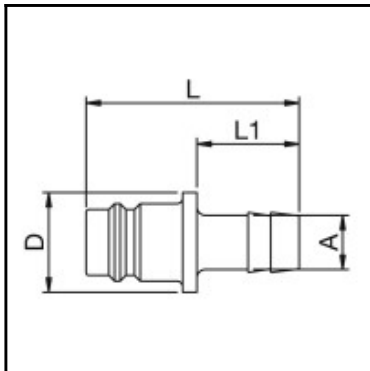

Description

Plug straight-through, hose barb 25mm (1), nominal diameter 19, <35 bar, brass

Compact industrial coupling system in brass for use with numerous gaseous and liquid medio. UltraFlo valve for optimum flow and low pressure drop.

Details

Series:	39
Series long:	39SF
Bore in mm:	19
Bore area in mm²:	300
Advantages:	Compact design. Extremely high flow rate. UltraFlo valve.
Working pressure:	35 bar maximum static working pressure with safety factor 4 to 1.
Working temperature:	-20°C up to +100°C (NBR) -40°C up to +120/150°C (EPDM) -15°C up to +200°C (FKM) 0°C up to +316°C (FFKM) depending on the medium.
Shut-Off:	Plug Straight-Through
Connection:	Hose barb 25mm LW(1")
Connection description:	Hose barb 25mm LW(1")
Connection type:	Hose barb
Material:	Brass
Material description:	Brass CuZn39Pb3 2.0401 (except sleeve)
Surface:	blank finish
Weight in kg:	0,1846
Self-venting coupling:	No
Safety locking system:	No
Single-hand operation:	Yes
Two-hand operation:	No
Ball locking:	No
Pin lock:	No
Ultra-FLO-valve:	No
Vacuum suitable:	Yes
Water-resistant:	Yes
Flat-sealing:	No
Suitable breath / respiratory protection:	No
Pressure eliminator:	No
Hydraulics:	No
Pneumatics:	Yes
Standard product:	No
Mould coupling:	No

Dimensions

Connection A:	25 mm
D mm:	35
L mm:	87
L1 mm:	48