

## Datasheet of 39SFTF19MXN Plug with hose barb

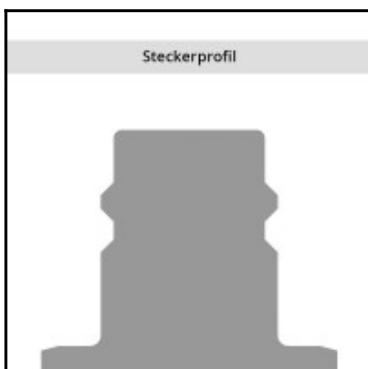
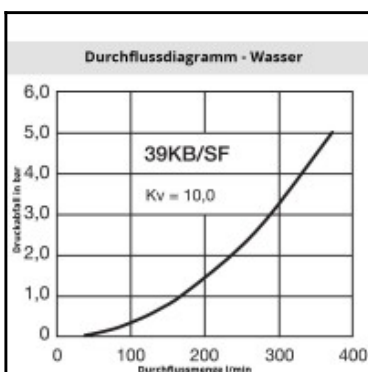
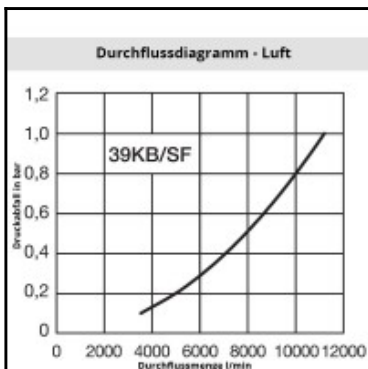
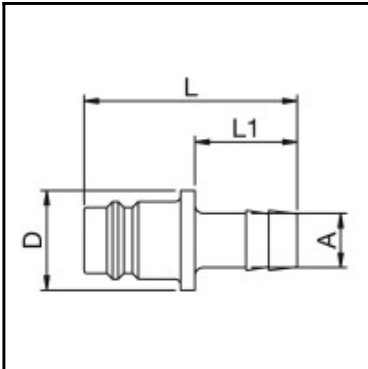

### Description

Plug straight-through, hose barb 19mm (3/4), nominal diameter 19, <35 bar, brass nickel plated

Compact industrial coupling system in brass for use with numerous gaseous and liquid medio. UltraFlo valve for optimum flow and low pressure drop.

### Details

Series:	39
Series long:	39SF
Bore in mm:	19
Bore area in mm²:	300
Advantages:	Compact design. Extremely high flow rate. UltraFlo valve.
Working pressure:	35 bar maximum static working pressure with safety factor 4 to 1.
Working temperature:	-20°C up to +100°C (NBR) -40°C up to +120/150°C (EPDM) -15°C up to +200°C (FKM) 0°C up to +316°C (FFKM) depending on the medium.
Shut-Off:	Plug Straight-Through
Connection:	Hose barb 19mm LW(3/4")
Connection description:	Hose barb 19mm LW(3/4")
Connection type:	Hose barb
Material:	Brass nickel plated
Material description:	Brass CuZn39Pb3 2.0401 (except sleeve)
Surface:	nickel plated
Weight in kg:	0,1344
Self-venting coupling:	No
Safety locking system:	No
Single-hand operation:	Yes
Two-hand operation:	No
Ball locking:	No
Pin lock:	No
Ultra-FLO-valve:	No
Vacuum suitable:	Yes
Water-resistant:	Yes
Flat-sealing:	No
Suitable breath / respiratory protection:	No
Pressure eliminator:	No
Hydraulics:	No
Pneumatics:	Yes
Standard product:	No
Mould coupling:	No

### Dimensions

Connection A:	19 mm
D mm:	35
L mm:	75
L1 mm:	36