

Datasheet of 39SBIW26MPN Plug with female thread

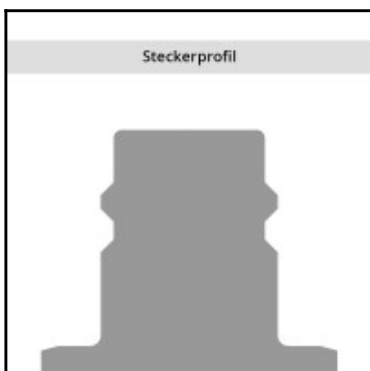
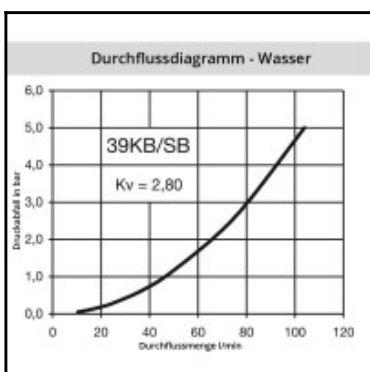
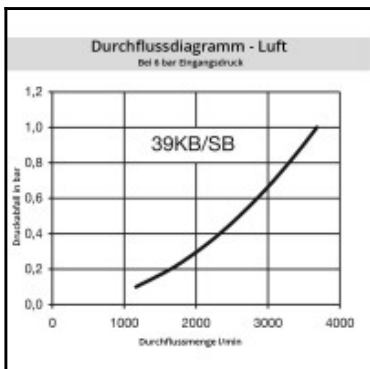
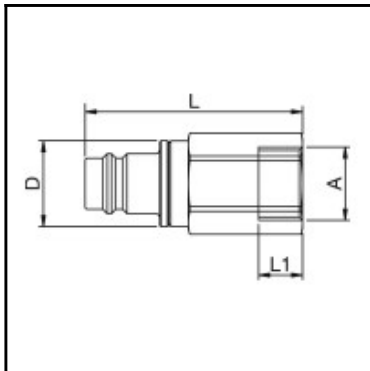

Description

Plug double shut-off, female thread G 3/4, nominal diameter 19, <35 bar, brass nickel plated, seal NBR

Compact industrial coupling system in brass for use with numerous gaseous and liquid medio. UltraFlo valve for optimum flow and low pressure drop.

Details

Series:	39
Series long:	39SB
Bore in mm:	19
Bore area in mm²:	300
Advantages:	Compact design. Extremely high flow rate. UltraFlo valve.
Working pressure:	35 bar maximum static working pressure with safety factor 4 to 1.
Working temperature:	-20°C up to +100°C (NBR) -40°C up to +120/150°C (EPDM) -15°C up to +200°C (FKM) 0°C up to +316°C (FFKM) depending on the medium.
Shut-Off:	Plug Double Shut-Off
Connection:	Female thread 3/4"
Connection description:	Female pipe thread of Whitworth form ISO 228 3/4"
Connection type:	Female thread
Material:	Brass nickel plated
Material description:	Brass CuZn39Pb3 2.0401 (except sleeve)
Seal description:	Nitrite-butadiene rubber
Surface:	nickel plated
Material connection:	Brass nickel plated
Material valve:	Brass
Material spring snap ring:	stainless steel AISI 301
Material seal:	Perbunan®
Weight in kg:	0,51
Self-venting coupling:	No
Safety locking system:	No
Single-hand operation:	Yes
Two-hand operation:	No
Ball locking:	No
Pin lock:	No
Ultra-FLO-valve:	No
Vacuum suitable:	Yes
Water-resistant:	Yes
Flat-sealing:	No
Suitable breath / respiratory protection:	No
Pressure eliminator:	No
Hydraulics:	No
Pneumatics:	Yes
Standard product:	No
Mould coupling:	No

Dimensions

Connection A:	G 3/4
L mm:	96
L1 mm:	19
SW mm:	41