

Datasheet of 29KFIW26SPZ Quick coupling with female thread

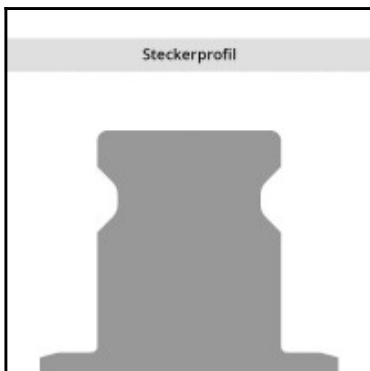
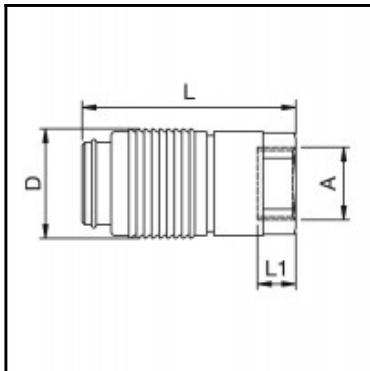

Description

Quick coupling straight-through, female thread G 3/4, nominal diameter 13, <35 bar, steel zinc plated, seal NBR

Robust coupling system in steel, which is particularly suited to use in the construction industry and mining. Coupling system with single-hand operation. UltraFlo valve for optimum flow and low pressure drop.

Details

Series:	29
Series long:	29KF
Bore in mm:	13
Bore area in mm²:	130
Advantages:	One-hand operation. Low pressure Drop. UltraFlo valve.
Compatibility:	RECTUS Design
Working pressure:	35 bar maximum static working pressure with safety factor 4 to 1.
Working temperature:	-20°C up to +100°C (NBR) -40°C up to +120/150°C (EPDM) -15°C up to +200°C (FKM) depending on the medium.
Shut-Off:	Quick coupling Straight-Through
Connection:	Female thread 3/4"
Connection description:	Female pipe thread of Whitworth form ISO 228 3/4"
Connection type:	Female thread
Material:	Galvanized steel
Material description:	Steel 9SMnPb28K 1.0718
Seal description:	Nitrite-butadiene rubber
Surface:	zinc plated
Material connection:	Galvanized steel
Material valve body:	Galvanized steel
Material sleeve:	Steel hardened and zinc plated
Material spring snap ring:	stainless steel AISI 301
Material balls/pins:	Stainless steel AISI 420
Material seal:	Perbunan®
Weight in kg:	0,3726
Self-venting coupling:	No
Safety locking system:	No
Single-hand operation:	Yes
Two-hand operation:	No
Ball locking:	Yes
Pin lock:	No
Ultra-FLO-valve:	No
Vacuum suitable:	Yes
Water-resistant:	No
Flat-sealing:	No
Suitable breath / respiratory protection:	No
Pressure eliminator:	No
Hydraulics:	No
Pneumatics:	Yes
Standard product:	No
Mould coupling:	No

Dimensions

Connection A:	G 3/4
D mm:	40
L mm:	78
L1 mm:	16