

## Datasheet of 57KBIW21BPN Quick coupling with female thread

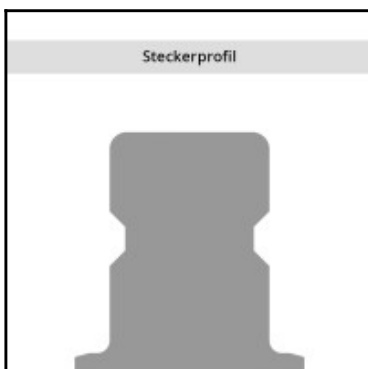
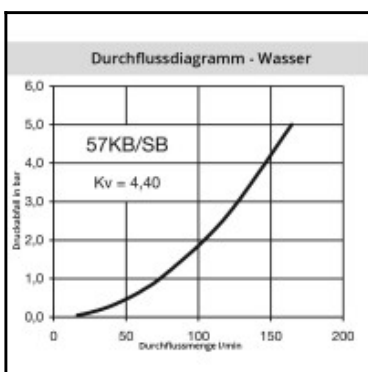
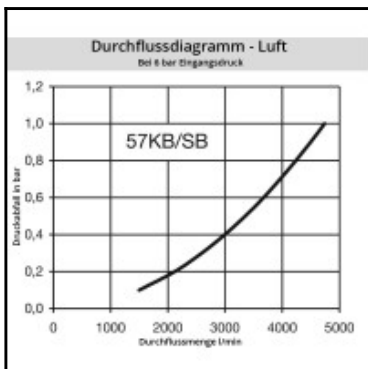
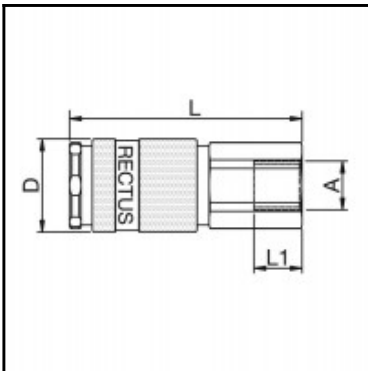

### Description

Quick coupling double shut-off, female thread G 1/2, nominal diameter 12, <35 bar, brass nickel plated, seal NBR

German industrial profile for compressed air applications. UltraFlo valve for optimum flow and low pressure drop. Robust structure, optimised with respect to size and performance. Especially suitable for oscillating forces due to steel sleeve and steel valve bodies. The collar design minimises damage to the valve body.

### Details

|   |  |
|---|--|
| Series:                                   | 57   |
| Series long:                              | 57KB   |
| Bore in mm:                               | 12   |
| Bore area in mm²:                         | 115  |
| Advantages:                               | One-hand operation. Low pressure Drop. UltraFlo valve. The collar design minimises damage to the valve body. |
| Working pressure:                         | 35 bar maximum static working pressure with safety factor 4 to 1.  |
| Working temperature:                      | -20°C up to +100°C (NBR) -40°C up to +120/150°C (EPDM) -15°C up to +200°C (FKM) depending on the medium.     |
| Shut-Off:                                 | Quick coupling Double Shut-Off   |
| Connection:                               | Female thread 1/2"   |
| Connection description:                   | Female pipe thread of Whitworth form ISO 228 1/2"  |
| Connection type:                          | Female thread  |
| Material:                                 | Brass nickel plated  |
| Material description:                     | Brass CuZn39Pb3 2.0401 (completely)  |
| Seal description:                         | Nitrite-butadiene rubber   |
| Surface:                                  | nickel plated  |
| Material connection:                      | Brass nickel plated  |
| Material valve body:                      | Brass nickel plated  |
| Material sleeve:                          | Brass nickel plated  |
| Material valve:                           | Brass nickel plated  |
| Material spring snap ring:                | stainless steel AISI 301   |
| Material balls/pins:                      | Stainless steel AISI 420   |
| Material seal:                            | Perbunan®  |
| Weight in kg:                             | 0,5943   |
| Self-venting coupling:                    | No   |
| Safety locking system:                    | No   |
| Single-hand operation:                    | Yes  |
| Two-hand operation:                       | No   |
| Ball locking:                             | Yes  |
| Pin lock:                                 | No   |
| Ultra-FLO-valve:                          | No   |
| Vacuum suitable:                          | Yes  |
| Water-resistant:                          | Yes  |
| Flat-sealing:                             | No   |
| Suitable breath / respiratory protection: | No   |
| Pressure eliminator:                      | No   |
| Hydraulics:                               | No   |
| Pneumatics:                               | Yes  |
| Standard product:                         | No   |
| Mould coupling:                           | No   |

### Dimensions

|               |       |
|---------------|-------|
| Connection A: | G 1/2 |
| D mm:         | 40    |
| L mm:         | 100   |
| L1 mm:        | 19    |
| SW mm:        | 34    |