

## Datasheet of 42SFTF13MXC Plug with hose barb

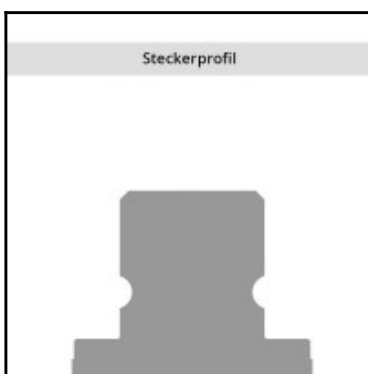
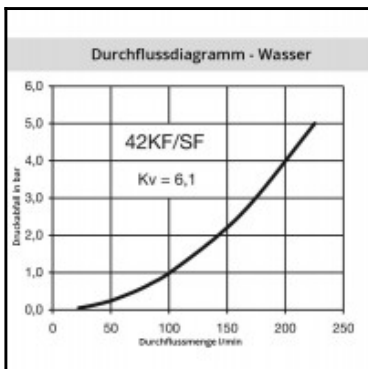
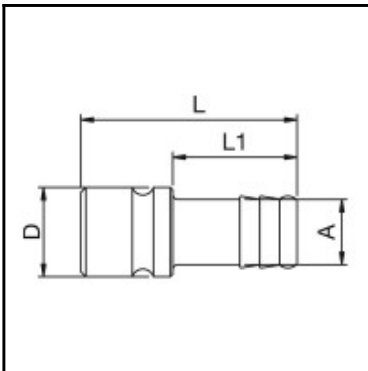

### Description

Plug straight-through, hose barb 13mm (1/2), nominal diameter 11, <35 bar, brass chrome plated

Brass coupling with no valve for applications with liquids in the pressure range up to 35 bar. The couplings are corrosion resistant. The system stands out for a high flow with minimal pressure drop.

### Details

Series:	42
Series long:	42SF
Bore in mm:	11
Bore area in mm²:	95
Advantages:	Non-corrosive. High flow. Minimal pressure drop.
Working pressure:	35 bar maximum static working pressure with safety factor 4 to 1.
Working temperature:	-20°C up to +100°C (NBR) -40°C up to +120/150°C (EPDM) -15°C up to +200°C (FKM) depending on the medium.
Shut-Off:	Plug Straight-Through
Connection:	Hose barb 13mm LW(1/2")
Connection description:	Hose barb 13mm LW(1/2")
Connection type:	Hose barb
Material:	brass chrome plated
Material description:	Brass CuZn39Pb3 2.0401 (except sleeve)
Surface:	chrome plated
Weight in kg:	0,031
Self-venting coupling:	No
Safety locking system:	No
Single-hand operation:	Yes
Two-hand operation:	No
Ball locking:	No
Pin lock:	No
Ultra-FLO-valve:	No
Vacuum suitable:	Yes
Water-resistant:	Yes
Flat-sealing:	No
Suitable breath / respiratory protection:	No
Pressure eliminator:	No
Hydraulics:	No
Pneumatics:	Yes
Standard product:	No
Mould coupling:	No

### Dimensions

Connection A:	13 mm
D mm:	15
L mm:	48
L1 mm:	25