

Datasheet of 34KAAK13SPN Quick coupling with male thread

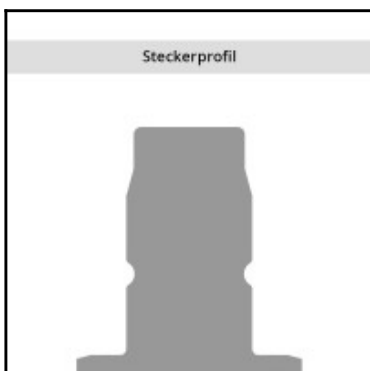
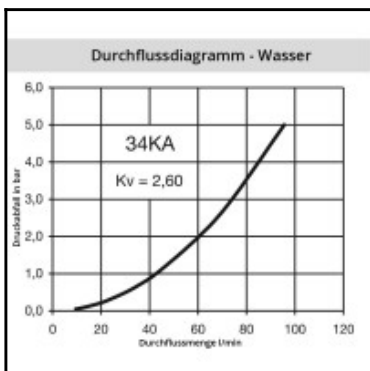
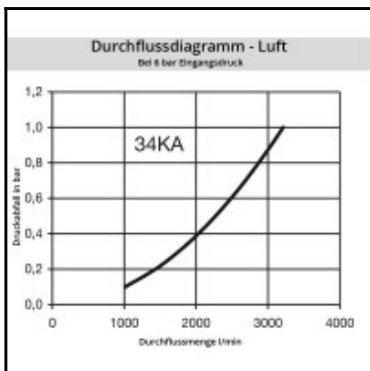
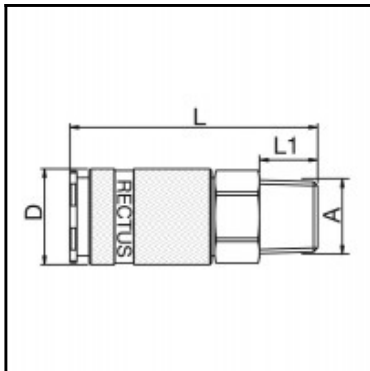

Description

Quick coupling single shut-off, male thread R 1/4, nominal diameter 10, <35 bar, steel nickel plated, seal NBR

Industrial coupling with Atlas Copco-Profile. Coupling system with single-hand operation. UltraFlo valve for optimum flow and low pressure drop. Optimal for use with large pneumatic consumers due to the robust design and steel sleeve. The collar design minimises damage to the valve body.

Details

Series:	34
Series long:	34KA
Bore in mm:	10
Bore area in mm²:	80
Advantages:	One-hand operation. Low pressure Drop. The collar design minimises damage to the valve body.
Working pressure:	35 bar maximum static working pressure with safety factor 4 to 1.
Working temperature:	-20°C up to +100°C (NBR) -40°C up to +120/150°C (EPDM) -15°C up to +200°C (FKM) depending on the medium.
Shut-Off:	Quick coupling Single Shut-Off
Connection:	Male thread 1/4"
Connection description:	Male tapered thread of Whitworth form DIN 2999 1/4"
Connection type:	Male thread
Material:	Steel nickel-plated
Material description:	Steel 9SMnPb28K 1.0718
Seal description:	Nitrite-butadiene rubber
Surface:	nickel plated
Material connection:	Brass nickel plated
Material valve body:	Steel nickel-plated
Material sleeve:	Steel hardened and nickel plated
Material valve:	Brass
Material spring snap ring:	stainless steel AISI 301
Material balls/pins:	1.3541
Material seal:	Perbunan®
Weight in kg:	0,1613
Self-venting coupling:	No
Safety locking system:	No
Single-hand operation:	Yes
Two-hand operation:	No
Ball locking:	No
Pin lock:	Yes
Ultra-FLO-valve:	No
Vacuum suitable:	Yes
Water-resistant:	No
Flat-sealing:	No
Suitable breath / respiratory protection:	No
Pressure eliminator:	No
Hydraulics:	No
Pneumatics:	Yes
Standard product:	No
Mould coupling:	No

Dimensions

Connection A:	R 1/4
D mm:	28
L mm:	70
L1 mm:	12
SW mm:	24