

## Datasheet of 27SFTF16SXN Plug with hose barb

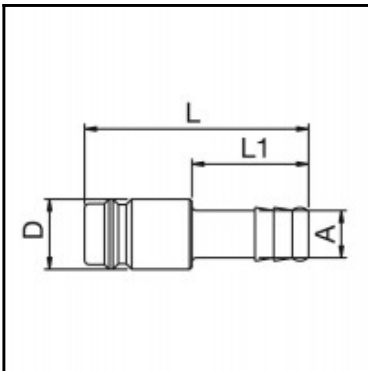

### Description

Plug straight-through, hose barb 16mm, nominal diameter 10, <35 bar, steel nickel plated

1/2 universal industrial coupling with standard European profile for use with large pneumatic consumers. Coupling system with single-hand operation. UltraFlo valve for optimum flow and low pressure drop. The series stands out for its robust design (steel sleeve), extremely high flow and long service life even with the harshest use. The collar design minimises damage to the valve body.

### Details

|   |  |
|---|--|
| Series:                                   | 27   |
| Series long:                              | 27SF   |
| Bore in mm:                               | 10   |
| Bore area in mm²:                         | 80   |
| Advantages:                               | One-hand operation. Low pressure Drop. The collar design minimises damage to the valve body. UltraFlo valve.                     |
| Compatibility:                            | RECTUS 41 RECTUS 1700 RECTUS 1727 TEMA 1700  |
| Working pressure:                         | 35 bar maximum static working pressure with safety factor 4 to 1.  |
| Working temperature:                      | -20°C up to +100°C (NBR) -40°C up to +120/150°C (EPDM) -15°C up to +200°C (FKM) 0°C up to +316°C (FFKM) depending on the medium. |
| Shut-Off:                                 | Plug Straight-Through  |
| Connection:                               | Hose barb 16mm   |
| Connection description:                   | Hose barb 16mm   |
| Connection type:                          | Hose barb  |
| Material:                                 | Steel nickel-plated  |
| Material description:                     | Steel 9SMnPb28K 1.0718   |
| Surface:                                  | nickel plated  |
| Weight in kg:                             | 0,0346   |
| Self-venting coupling:                    | No   |
| Safety locking system:                    | No   |
| Single-hand operation:                    | Yes  |
| Two-hand operation:                       | No   |
| Ball locking:                             | No   |
| Pin lock:                                 | No   |
| Ultra-FLO-valve:                          | No   |
| Vacuum suitable:                          | No   |
| Water-resistant:                          | No   |
| Flat-sealing:                             | No   |
| Suitable breath / respiratory protection: | No   |
| Pressure eliminator:                      | No   |
| Hydraulics:                               | No   |
| Pneumatics:                               | Yes  |
| Standard product:                         | Yes  |
| Mould coupling:                           | No   |

### Dimensions

|               |       |
|---------------|-------|
| Connection A: | 16 mm |
| D mm:         | 18    |
| L mm:         | 48    |
| L1 mm:        | 25    |