

## Datasheet of 30SFTF06SXN Plug with hose barb

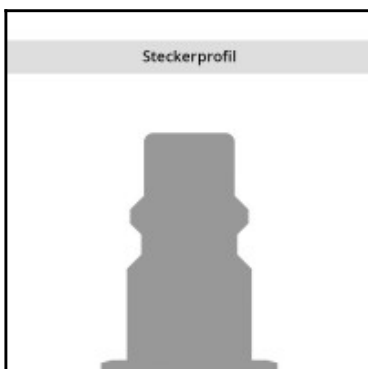
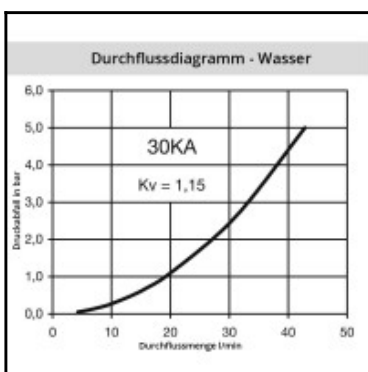
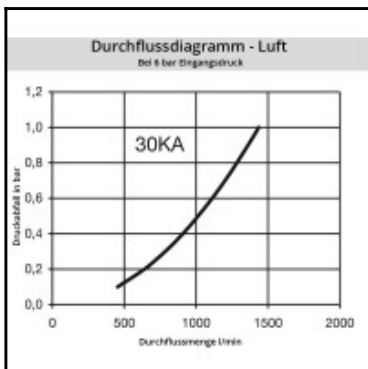
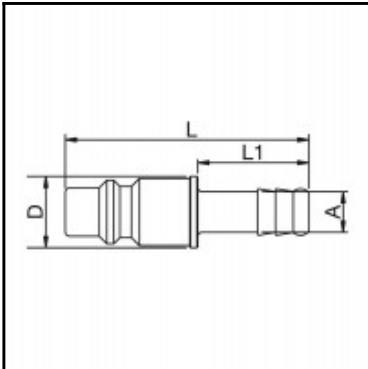

### Description

Plug straight-through, hose barb 6mm (1/4), nominal diameter 8,5, <35 bar, steel nickel plated

Steel coupling 3/8 according to ISO 6150 B and US MIL-SPEC 4109. Very robust design with steel valve bodies. The high insertion depth is guaranteed by an optimised plug guide.

### Details

Series:	30
Series long:	30SF
Bore in mm:	8,5
Bore area in mm²:	60
Advantages:	Very robust design with steel valve body.
Compatibility:	INDUSTRIAL INTERCHANGE 3/8" US-MIL-SPEC-C-4109 ISO 6150 C PARKER 30 3/8"
Working pressure:	35 bar maximum static working pressure with safety factor 4 to 1.
Working temperature:	-20°C up to +100°C (NBR) -40°C up to +120/150°C (EPDM) -15°C up to +200°C (FKM) depending on the medium.
Shut-Off:	Plug Straight-Through
Connection:	Hose barb 6mm LW(1/4")
Connection description:	Hose barb 6mm LW(1/4")
Connection type:	Hose barb
Material:	Steel nickel-plated
Material description:	Steel 9SMnPb28K 1.0718
Surface:	nickel plated
Weight in kg:	0,0261
Self-venting coupling:	No
Safety locking system:	No
Single-hand operation:	Yes
Two-hand operation:	No
Ball locking:	No
Pin lock:	No
Ultra-FLO-valve:	No
Vacuum suitable:	Yes
Water-resistant:	No
Flat-sealing:	No
Suitable breath / respiratory protection:	No
Pressure eliminator:	No
Hydraulics:	No
Pneumatics:	Yes
Standard product:	No
Mould coupling:	No

### Dimensions

Connection A:	6 mm
D mm:	16
L mm:	55
L1 mm:	25