

Datasheet of 45SFAW13SXN Plug with male thread

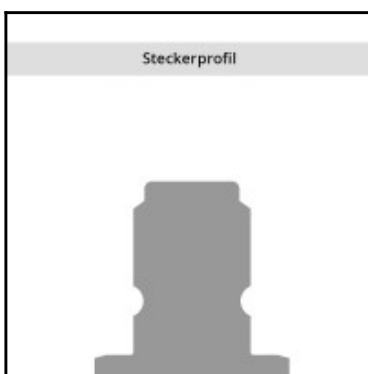
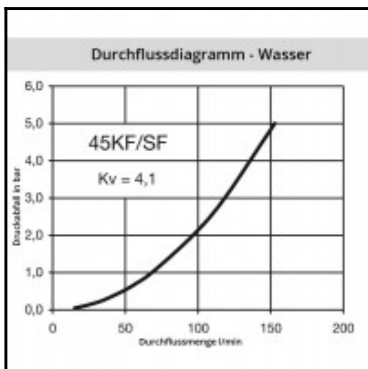
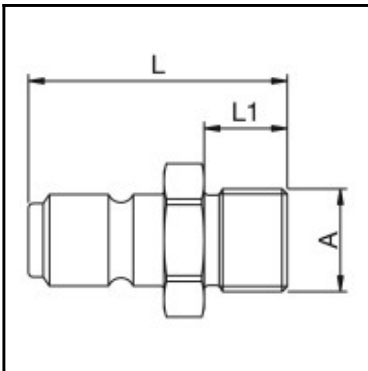

Description

Plug straight-through, male thread G 1/4, nominal diameter 8,5, <150 bar, steel nickel plated

Brass coupling with no valve for applications with non-aggressive liquids in the pressure range up to 150 bar. The couplings are corrosion resistant. The system stands out for a high flow with minimal pressure drop.

Details

Series:	45
Series long:	45SF
Bore in mm:	8,5
Bore area in mm²:	60
Advantages:	Non-corrosive. High flow. Minimal pressure drop.
Compatibility:	PARKER
Working pressure:	150 bar maximum static working pressure with safety factor 4 to 1.
Working temperature:	-20°C up to +100°C (NBR) -40°C up to +120/150°C (EPDM) -15°C up to +200°C (FKM) depending on the medium.
Shut-Off:	Plug Straight-Through
Connection:	Male thread 1/4"
Connection description:	Male pipe thread of Whitworth form ISO 228 1/4"
Connection type:	Male thread
Material:	Steel nickel-plated
Material description:	Steel 9SMnPb28K 1.0718
Surface:	nickel plated
Weight in kg:	0,0351
Self-venting coupling:	No
Safety locking system:	No
Single-hand operation:	Yes
Two-hand operation:	No
Ball locking:	No
Pin lock:	No
Ultra-FLO-valve:	No
Vacuum suitable:	Yes
Water-resistant:	No
Flat-sealing:	No
Suitable breath / respiratory protection:	No
Pressure eliminator:	No
Hydraulics:	No
Pneumatics:	Yes
Standard product:	No
Mould coupling:	No

Dimensions

Connection A:	G 1/4
L mm:	42
L1 mm:	13,5
SW mm:	19