

## Datasheet of 33SFTF08SXN Plug with hose barb

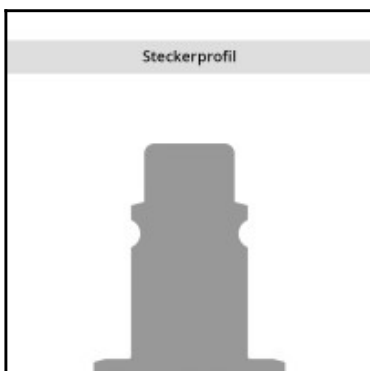
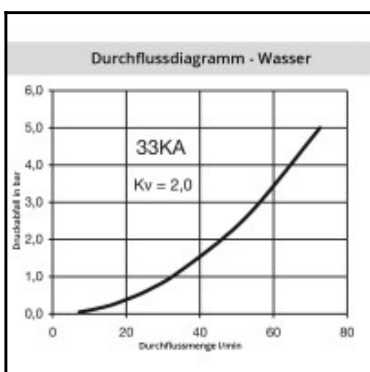
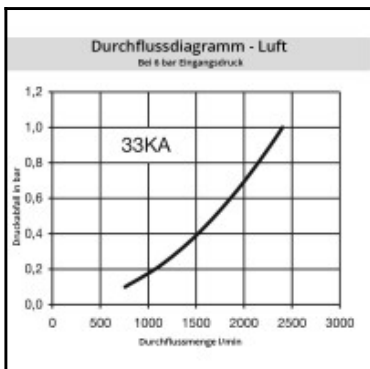
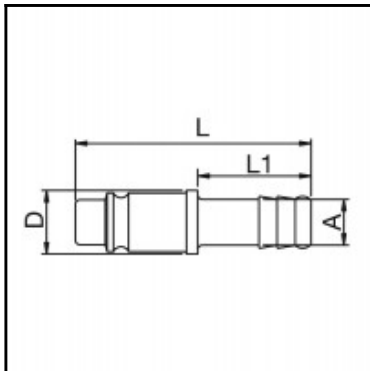

### Description

Plug straight-through, hose barb 8mm (5/16), nominal diameter 8, <35 bar, steel nickel plated

Steel industrial coupling with Atlas Copco-Profile. Specially suited to use with gaseous media in industry. Coupling system with single-hand operation. UltraFlo valve for optimum flow and low pressure drop.

### Details

|   |  |
|---|--|
| Series:                                   | 33   |
| Series long:                              | 33SF   |
| Bore in mm:                               | 8  |
| Bore area in mm²:                         | 50   |
| Advantages:                               | One-hand operation. Extremely high throughput through optimized valve construction. UltraFlo valve.      |
| Working pressure:                         | 35 bar maximum static working pressure with safety factor 4 to 1.  |
| Working temperature:                      | -20°C up to +100°C (NBR) -40°C up to +120/150°C (EPDM) -15°C up to +200°C (FKM) depending on the medium. |
| Shut-Off:                                 | Plug Straight-Through  |
| Connection:                               | Hose barb 8mm LW(5/16")  |
| Connection description:                   | Hose barb 8mm LW(5/16")  |
| Connection type:                          | Hose barb  |
| Material:                                 | Steel nickel-plated  |
| Material description:                     | Steel 9SMnPb28K 1.0718   |
| Surface:                                  | nickel plated  |
| Weight in kg:                             | 0,0199   |
| Self-venting coupling:                    | No   |
| Safety locking system:                    | No   |
| Single-hand operation:                    | Yes  |
| Two-hand operation:                       | No   |
| Ball locking:                             | No   |
| Pin lock:                                 | No   |
| Ultra-FLO-valve:                          | No   |
| Vacuum suitable:                          | Yes  |
| Water-resistant:                          | No   |
| Flat-sealing:                             | No   |
| Suitable breath / respiratory protection: | No   |
| Pressure eliminator:                      | No   |
| Hydraulics:                               | No   |
| Pneumatics:                               | Yes  |
| Standard product:                         | No   |
| Mould coupling:                           | No   |

### Dimensions

|               |      |
|---------------|------|
| Connection A: | 8 mm |
| D mm:         | 14   |
| L mm:         | 52   |
| L1 mm:        | 25   |