

Datasheet of 13SFTF08SXN Plug with hose barb

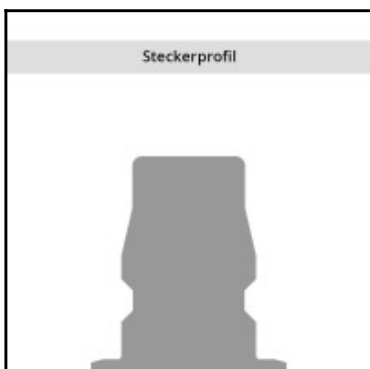
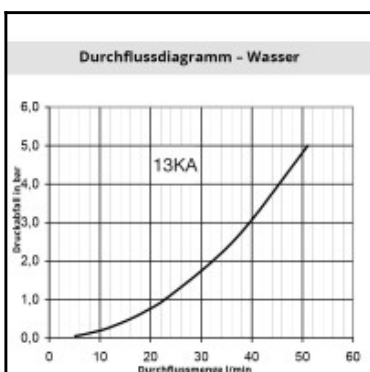
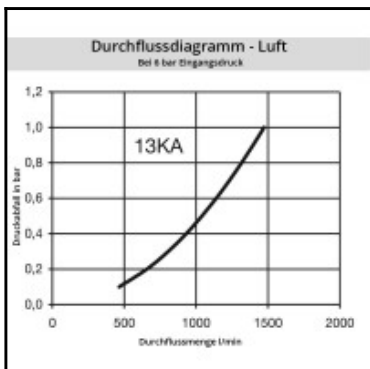
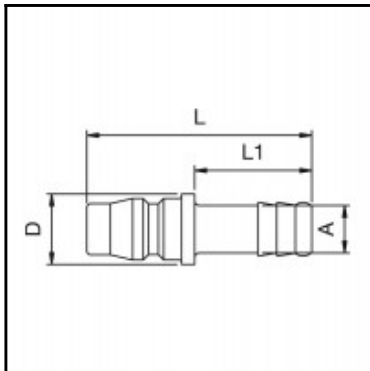

Description

Plug straight-through, hose barb 8mm (5/16), nominal diameter 7,5, <35 bar, steel nickel plated

Robust brass coupling with Japanese industrial profile. Coupling system with single-hand operation. Above average flow volumes and structure resistant to the effects of external forces.

Details

| | |
|---|--|
| Series: | 13 |
| Series long: | 13SF |
| Bore in mm: | 7,5 |
| Bore area in mm²: | 45 |
| Advantages: | One-hand operation. Corrosion free. |
| Compatibility: | RECTUS 03 |
| Working pressure: | 35 bar maximum static working pressure with safety factor 4 to 1. |
| Working temperature: | -20°C up to +100°C (NBR) -40°C up to +120/150°C (EPDM) -15°C up to +200°C (FKM) depending on the medium. |
| Shut-Off: | Plug Straight-Through |
| Connection: | Hose barb 8mm LW(5/16") |
| Connection description: | Hose barb 8mm LW(5/16") |
| Connection type: | Hose barb |
| Material: | Steel nickel-plated |
| Material description: | Steel 9SMnPb28K 1.0718 |
| Surface: | nickel plated |
| Weight in kg: | 0,0199 |
| Self-venting coupling: | No |
| Safety locking system: | No |
| Single-hand operation: | Yes |
| Two-hand operation: | No |
| Ball locking: | No |
| Pin lock: | No |
| Ultra-FLO-valve: | No |
| Vacuum suitable: | Yes |
| Water-resistant: | No |
| Flat-sealing: | No |
| Suitable breath / respiratory protection: | No |
| Pressure eliminator: | No |
| Hydraulics: | No |
| Pneumatics: | Yes |
| Standard product: | No |
| Mould coupling: | No |

Dimensions

| | |
|---------------|------|
| Connection A: | 8 mm |
| D mm: | 15 |
| L mm: | 48 |
| L1 mm: | 25 |