

Datasheet of 22SFTF06MXN Plug with hose barb

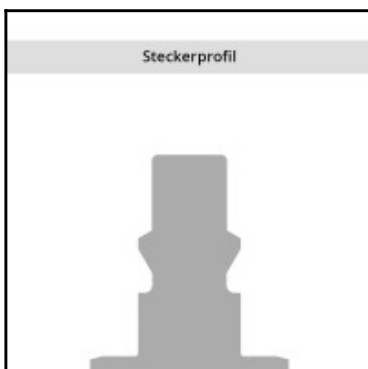
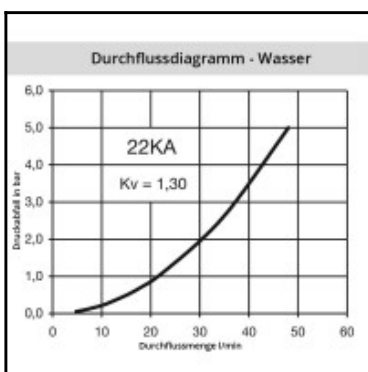
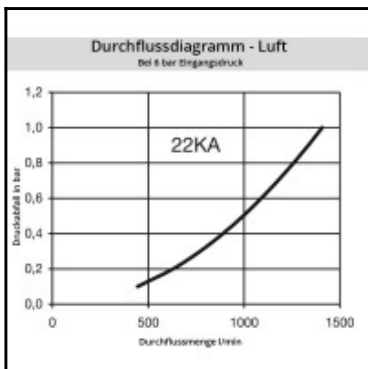
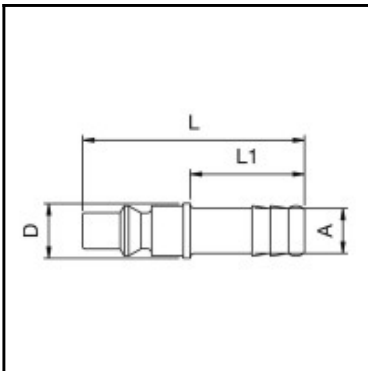

Description

Plug straight-through, hose barb 6mm (1/4), nominal diameter 5,5, <35 bar, brass nickel plated

Coupling system with single-hand operation. UltraFlo valve for optimum flow and low pressure drop. Specially suited to use with gaseous media in industry. The steel sleeve counters oscillating forces. The high insertion depth is guaranteed by an optimised plug guide.

Details

| | |
|---|--|
| Series: | 22 |
| Series long: | 22SF |
| Bore in mm: | 5,5 |
| Bore area in mm²: | 25 |
| Advantages: | One-hand operation. The high insertion depth is guaranteed by an optimised plug guide. UltraFlo valve. |
| Compatibility: | RECTUS 14, PARKER 50 |
| Working pressure: | 35 bar maximum static working pressure with safety factor 4 to 1. |
| Working temperature: | -20°C up to +100°C (NBR) -40°C up to +120/150°C (EPDM) -15°C up to +200°C (FKM) depending on the medium. |
| Shut-Off: | Plug Straight-Through |
| Connection: | Hose barb 6mm LW(1/4") |
| Connection description: | Hose barb 6mm LW(1/4") |
| Connection type: | Hose barb |
| Material: | Brass nickel plated |
| Material description: | Brass CuZn39Pb3 2.0401 (except sleeve) |
| Surface: | nickel plated |
| Weight in kg: | 0,013 |
| Self-venting coupling: | No |
| Safety locking system: | No |
| Single-hand operation: | Yes |
| Two-hand operation: | No |
| Ball locking: | No |
| Pin lock: | No |
| Ultra-FLO-valve: | No |
| Vacuum suitable: | Yes |
| Water-resistant: | No |
| Flat-sealing: | No |
| Suitable breath / respiratory protection: | No |
| Pressure eliminator: | No |
| Hydraulics: | No |
| Pneumatics: | Yes |
| Standard product: | No |
| Mould coupling: | No |

Dimensions

| | |
|---------------|------|
| Connection A: | 6 mm |
| D mm: | 12 |
| L mm: | 49 |
| L1 mm: | 25 |