

## Datasheet of 21KFKO06MPN0 Quick coupling with tube nut

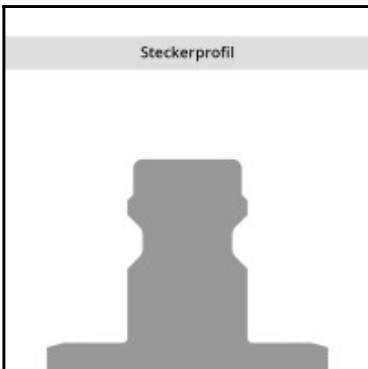
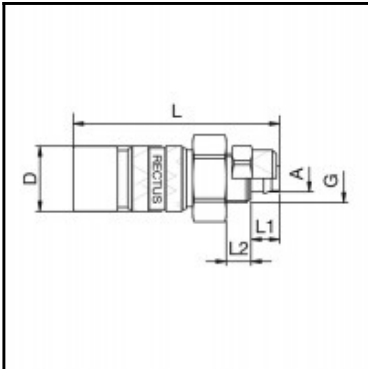

### Description

Quick coupling straight-through, coded system (0 = green, circle), with hose nut 4 x 6 mm, nominal diameter 5, <35 bar, brass nickel plated, seal NBR

Coded industrial coupling system developed on the basis of series 21 with above-average flow rate for liquid and gaseous media. Coupling system with single-hand operation. The mechanical coding of the coupling and plug offers a guarantee for avoiding mix-ups between media when coupling, which is complemented by the color coding of the anodised sleeves. Double shut-off version available on request.

### Details

Series:	21
Series long:	21KF
Bore in mm:	5
Bore area in mm²:	20
Advantages:	Quality product. One-hand operation.
Working pressure:	35 bar maximum static working pressure with safety factor 4 to 1.
Working temperature:	-20°C up to +100°C (NBR)
Shut-Off:	Quick coupling Straight-Through
Connection:	with tube nut 4 x 6 mm
Connection description:	with tube nut 4 x 6 mm
Connection type:	Connection nut
Material:	Brass nickel plated
Material description:	Brass CuZn39Pb3 2.0401 (except sleeve)
Seal description:	Nitrile-butadiene rubber
Surface:	nickel plated
Coding:	0 = green, circle
Material connection:	Brass nickel plated
Material valve body:	Brass nickel plated
Material sleeve:	Brass nickel plated
Material spring snap ring:	stainless steel AISI 301
Material balls/pins:	Stainless steel AISI 420
Material seal:	Perbunan®
Coded:	Yes
Self-venting coupling:	No
Safety locking system:	No
Single-hand operation:	Yes
Two-hand operation:	No
Ball locking:	Yes
Pin lock:	No
Ultra-FLO-valve:	No
Vacuum suitable:	Yes
Water-resistant:	Yes
Flat-sealing:	No
Suitable breath / respiratory protection:	No
Pressure eliminator:	No
Hydraulics:	No
Pneumatics:	Yes
Standard product:	No
Mould coupling:	No

### Dimensions

Connection A:	4 x 6 mm
D mm:	16
G mm:	M10x1
L mm:	51
L1 mm:	7
L2 mm:	6
SW mm:	14